

Traverse# 17
 N: 3518377.4430
 E: 5661287.9870
 Elev: 871.358

Traverse# 16
 N: 3518236.9580
 E: 5661105.6960
 Elev: 856.687

Point	Northing	Easting	Elev	Code	Description
16	3518237	5661106	856.687	CP 16 EAST CAVE	PK NAIL IN ASPHALT SOUTHSIDE ROAD ACROSS OLD HOUSE
17	3518377	5661288	871.358	CP PK ENTER	PK NAIL IN ASPHALT AT SOUTH SIDE ENTRANCE PORTAL

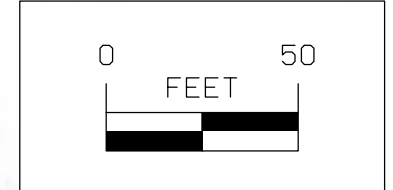

NO.	BY DATE	REVISION

DRAWN BY: PROJECT NUMBER:
 17-06-49-02
 CHK'D BY: DATE:
 October 2017

SURVEY CONTROL SHEET
 ROADWAY RECONSTRUCTION, MAINTENANCE &
 CAMPGROUND ELECTRICAL FOR:
MAQUOKETA CAVES STATE PARK
 JACKSON COUNTY, IOWA

IOWA DEPARTMENT OF NATURAL RESOURCES
 ENGINEERING SERVICES • WALLACE BUILDING
 502 E. 9TH ST., DES MOINES, IA 50319-0034

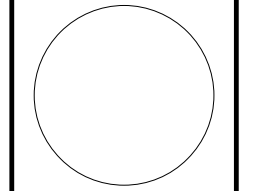

CONSULTANT:

9:42:27 AM 10/27/2017 maldric N:\Conservation Recreation\Land and Waters\Engineering\PROJECTS\ACTIVE\JACKSON\17-06-49-02 Maquoketa Caves Road Reconstr...Repair\02 Design\17-06-49-02 Maquoketa Caves Road Reconstr...Repair\02

Station	Left Lane	Right Lane
7+40	2.00% out - 11'	2.00% out - 11'
7+75.42	2.00% out - 11'	2.00% in - 11'
8+25	2.00% out - 11'	2.00% out - 11'

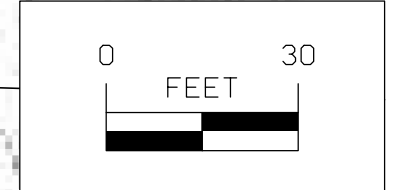
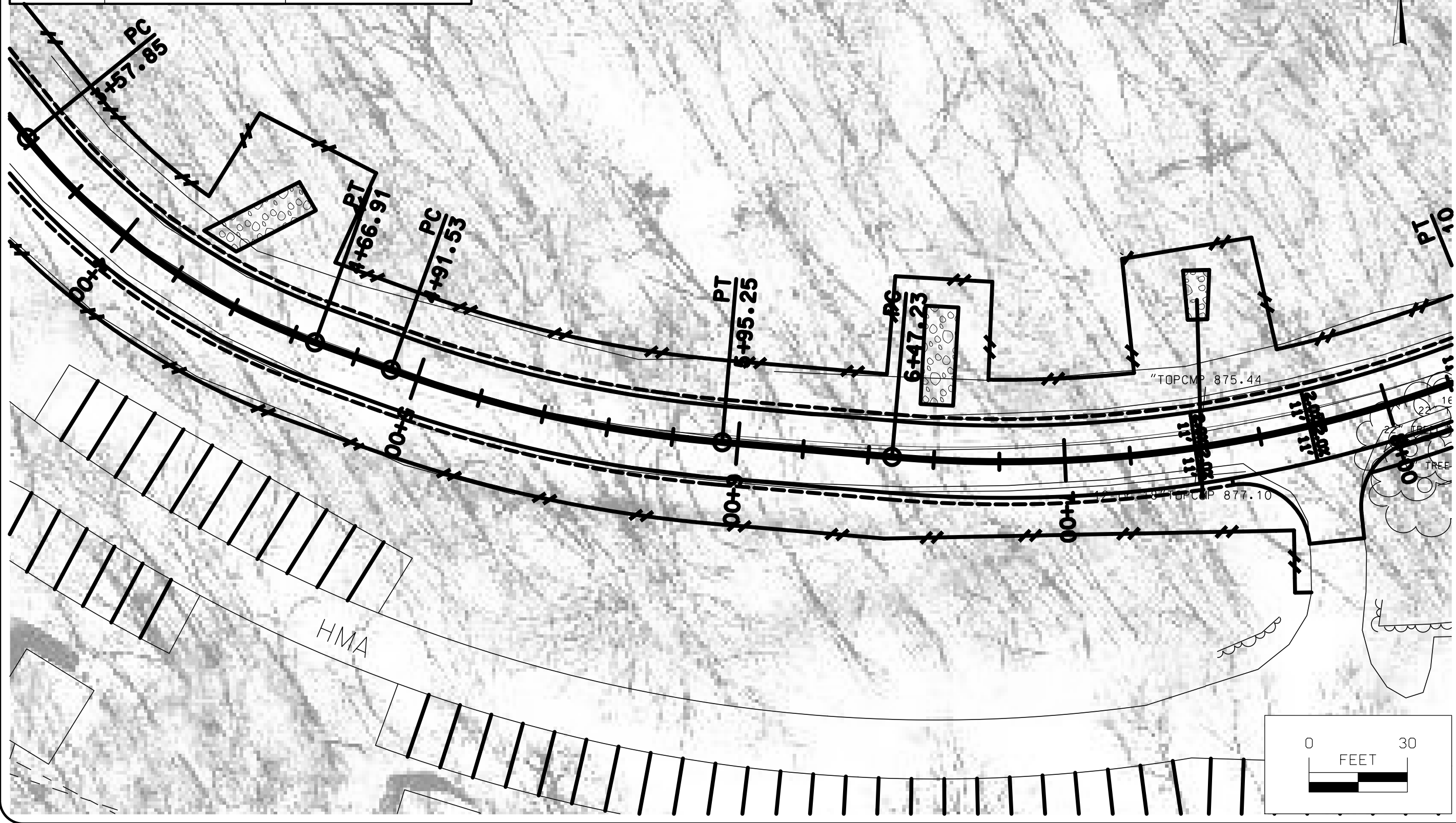

CONSULTANT:

IOWA DEPARTMENT OF NATURAL RESOURCES
 ENGINEERING SERVICES • WALLACE BUILDING
 502 E. 9TH ST., DES MOINES, IA 50319-0034

DNR

PAVEMENT SLOPE SHEET
 ROADWAY RECONSTRUCTION, MAINTENANCE & CAMPGROUND ELECTRICAL FOR:
MAQUOKETA CAVES STATE PARK
 JACKSON COUNTY, IOWA

NO.	BY	REVISION

DRAWN BY: PROJECT NUMBER:
 17-06-49-02

CHK'D BY: DATE:
 October 2017

S.02

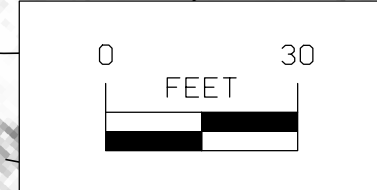
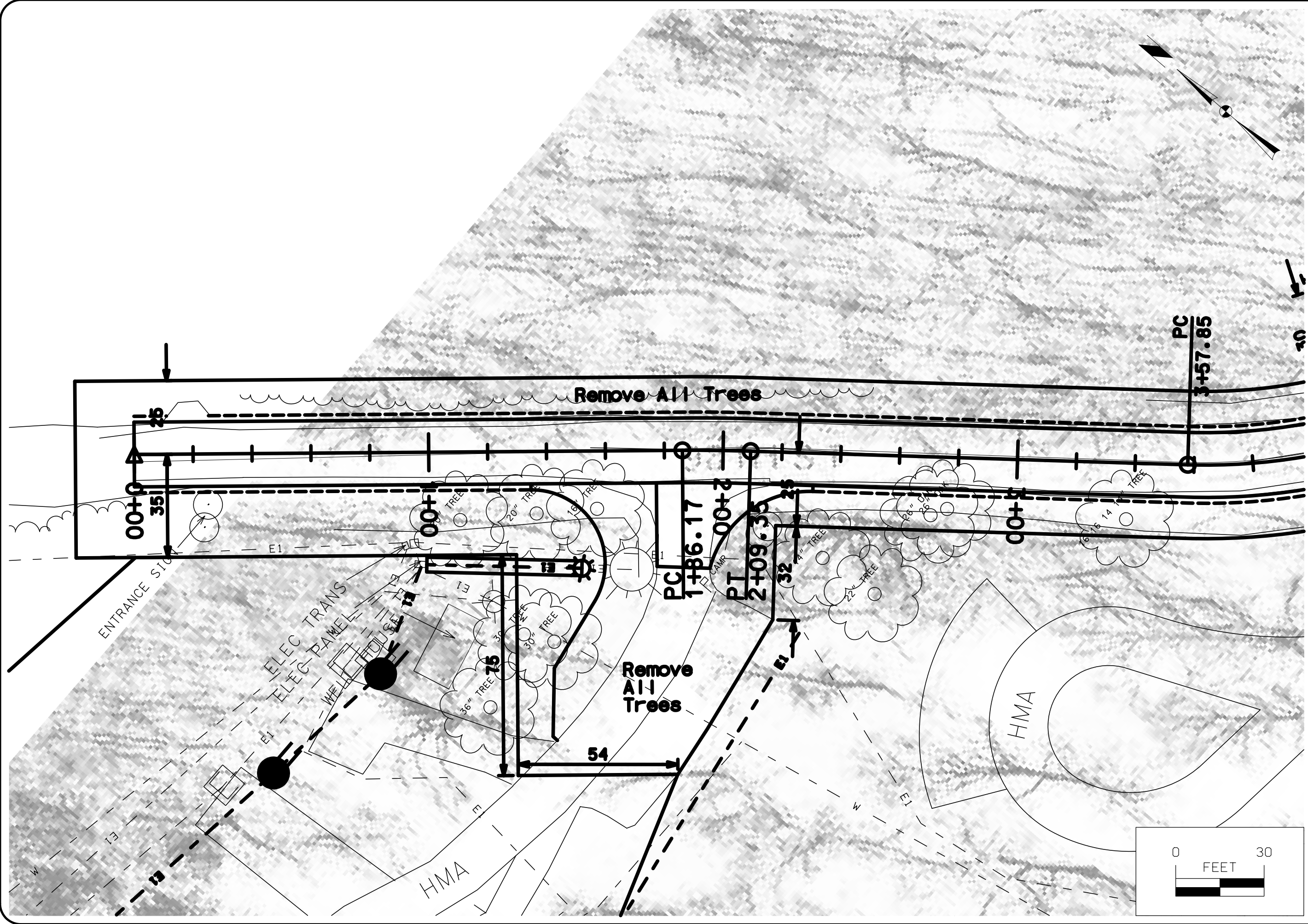

NO.	BY	REVISION

DRAWN BY: PROJECT NUMBER:
17-06-49-02
CHK'D BY: DATE:
October 2017

TREE REMOVAL SHEET
ROADWAY RECONSTRUCTION, MAINTENANCE &
CAMPGROUND ELECTRICAL FOR:
MAQUOKETA CAVES STATE PARK
JACKSON COUNTY, IOWA

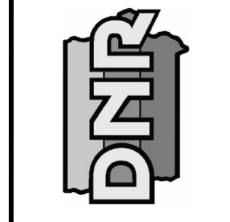

**IOWA DEPARTMENT OF
NATURAL RESOURCES**
ENGINEERING SERVICES - WALLACE BUILDING
502 E. 9TH ST., DES MOINES, IA 50319-0034

CONSULTANT:

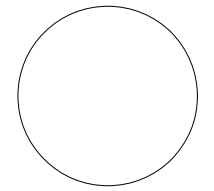

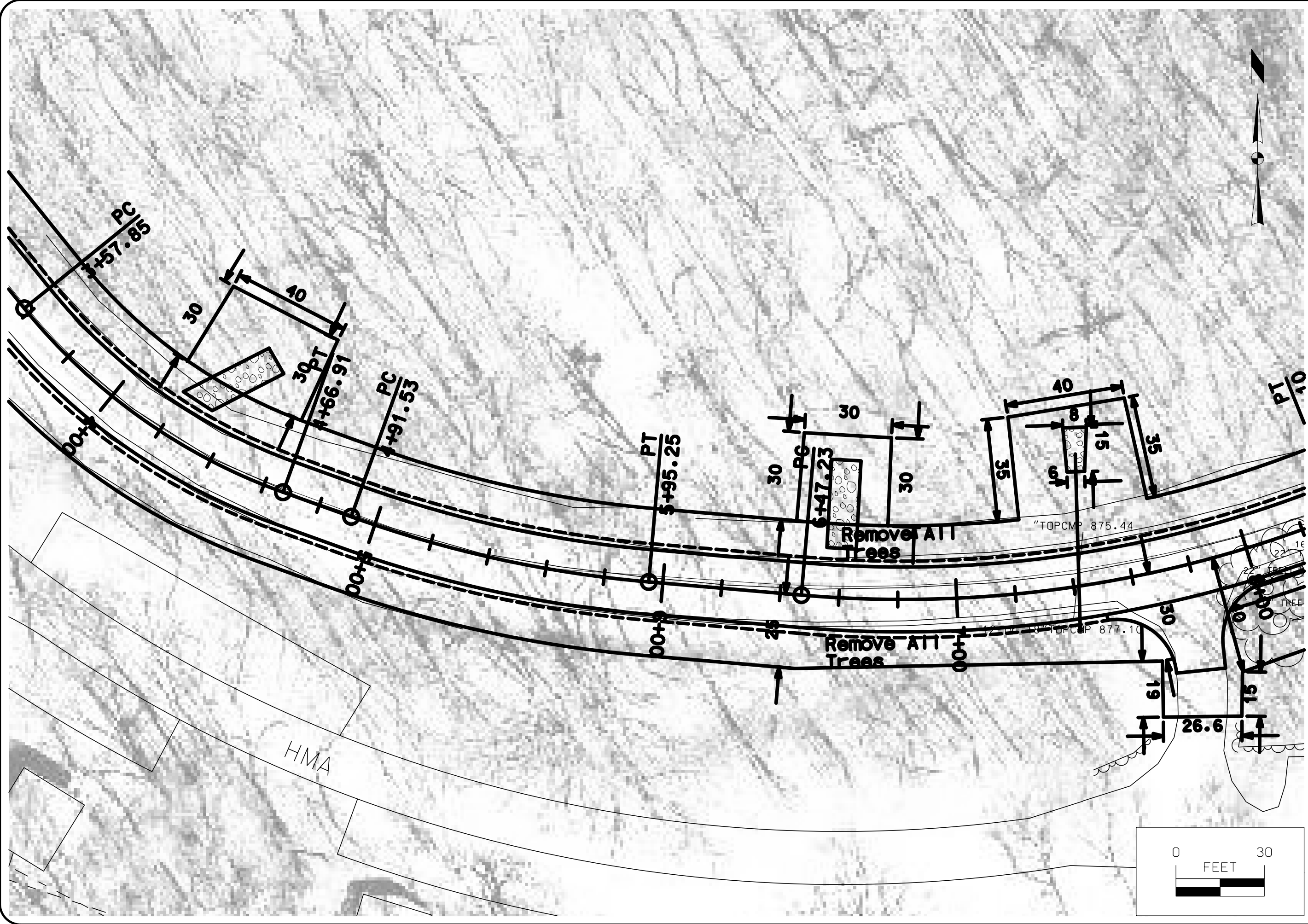

CONSULTANT:

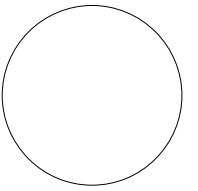

IOWA DEPARTMENT OF NATURAL RESOURCES

ENGINEERING SERVICES • WALLACE BUILDING
502 E. 9TH ST., DES MOINES, IA 50319-0034



TREE REMOVAL SHEET

ROADWAY RECONSTRUCTION, MAINTENANCE & CAMPGROUND ELECTRICAL FOR:

MAQUOKETA CAVES STATE PARK

JACKSON COUNTY, IOWA

NO.	BY	REVISION

DRAWN BY: PROJECT NUMBER:
17-06-49-02

CHK'D BY: DATE:
October 2017

9:43:29 AM 10/27/2017 maldric

N:\Conservation Recreation\Land and Waters\Engineering\PROJECTS\ACTIVE\JACKSON\17-06-49-02 Maquoketa Caves Road Reconstr-Repair\02 Design\17-06-49-02 Maquoketa Caves Road Reconstr.t

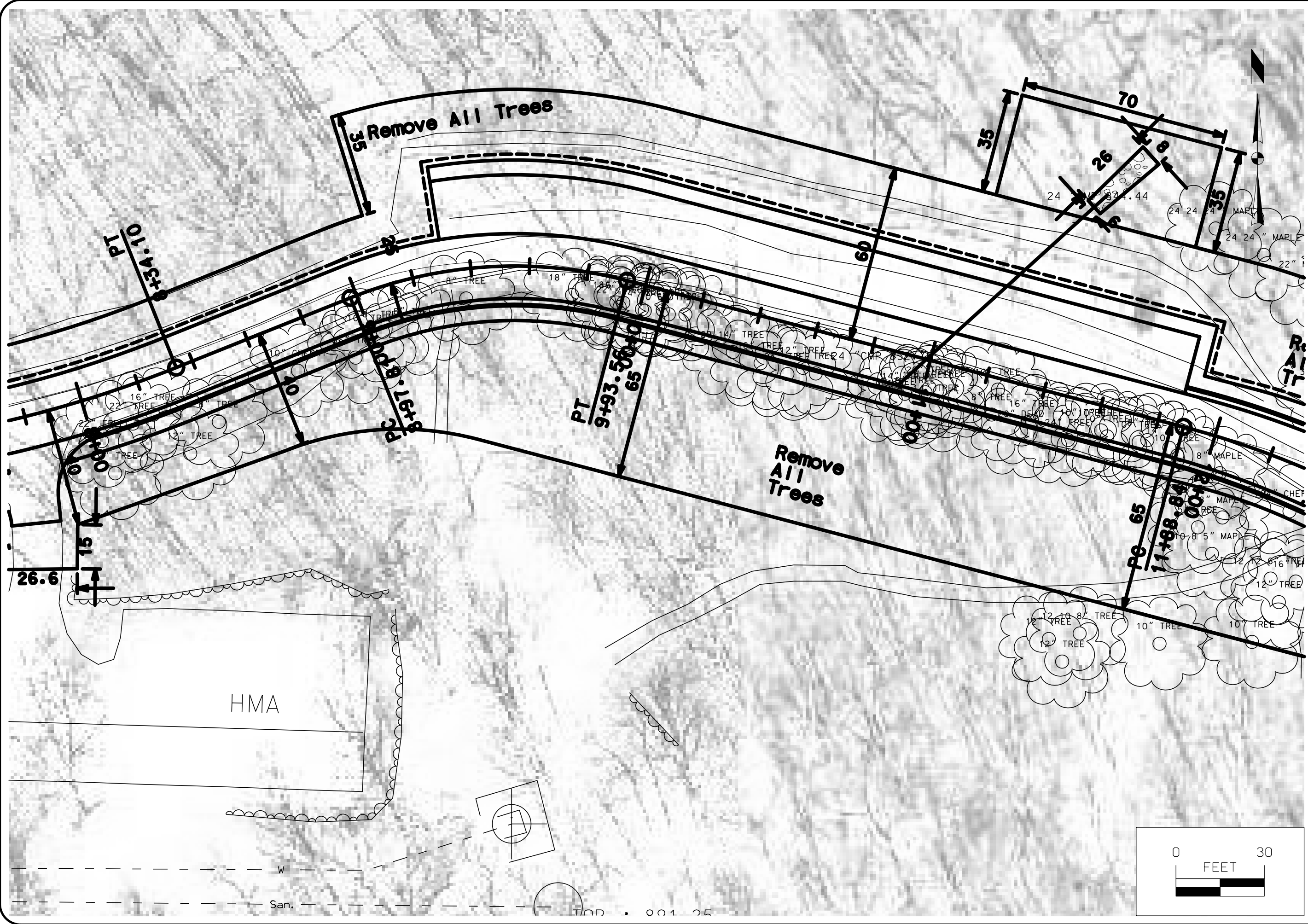

CONSULTANT:

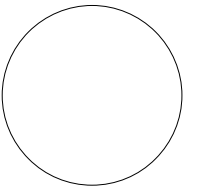

**IOWA DEPARTMENT OF
NATURAL RESOURCES**

ENGINEERING SERVICES • WALLACE BUILDING
502 E. 9TH ST., DES MOINES, IA 50319-0034



TREE REMOVAL SHEET

ROADWAY RECONSTRUCTION, MAINTENANCE &
CAMPGROUND ELECTRICAL FOR:

MAQUOKETA CAVES STATE PARK

JACKSON COUNTY, IOWA

NO.	BY	REVISION

DRAWN BY: PROJECT NUMBER:
17-06-49-02
CHK'D BY: DATE:
October 2017

T.03



NO.	BY	REVISION
DATE		

DRAWN BY: PROJECT NUMBER:
17-06-49-02

CHKD BY: DATE:
October 2017

TREE REMOVAL SHEET
ROADWAY RECONSTRUCTION, MAINTENANCE &
CAMPGROUND ELECTRICAL FOR:
MAQUOKETA CAVES STATE PARK
JACKSON COUNTY, IOWA

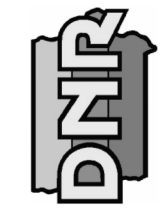

**IOWA DEPARTMENT OF
NATURAL RESOURCES**
ENGINEERING SERVICES - WALLACE BUILDING
502 E. 9TH ST., DES MOINES, IA 50319-0034

CONSULTANT:

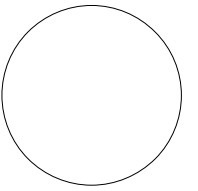

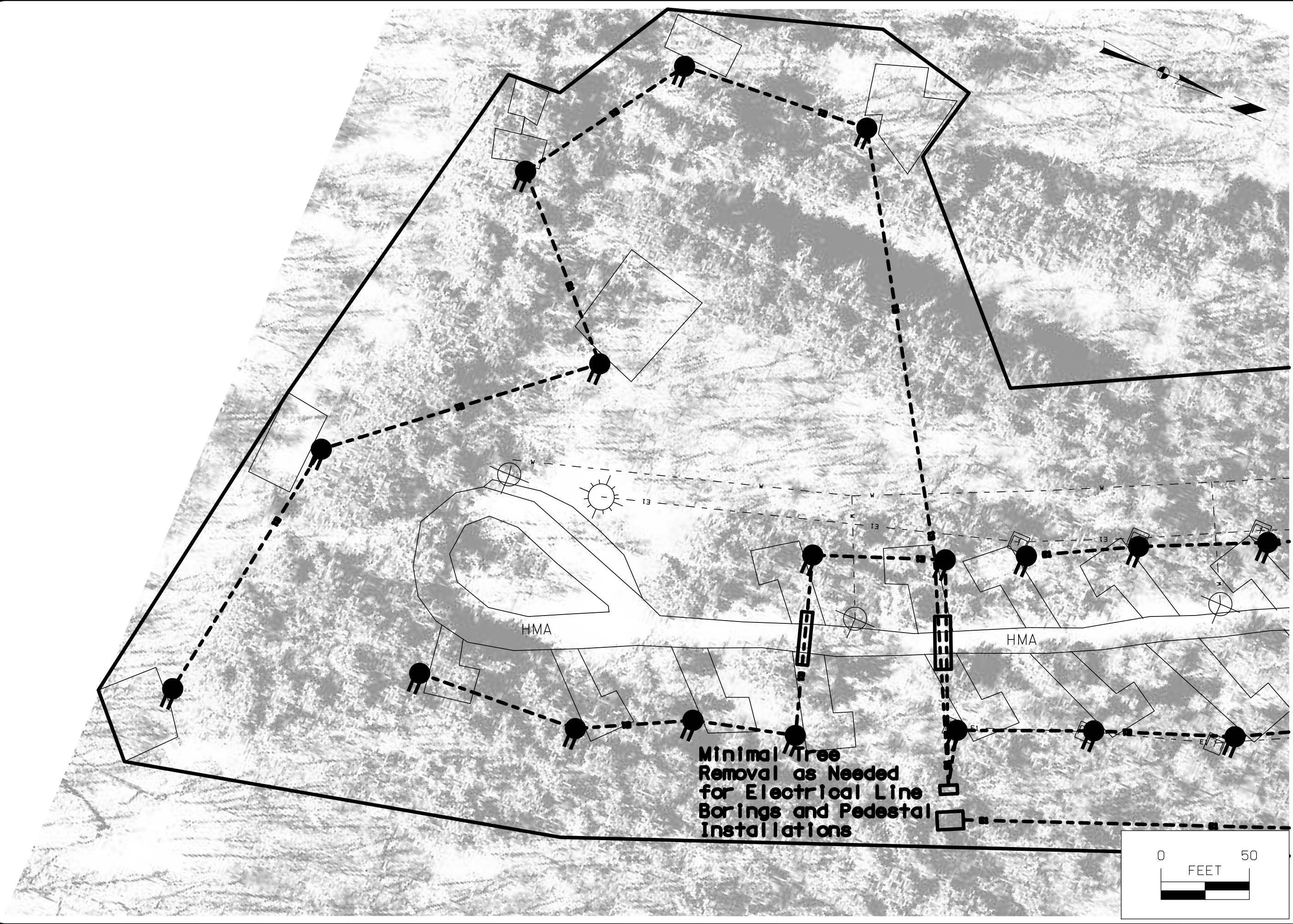

CONSULTANT:

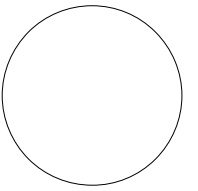

IOWA DEPARTMENT OF NATURAL RESOURCES
 ENGINEERING SERVICES - WALLACE BUILDING
 502 E. 9TH ST., DES MOINES, IA 50319-0034



TREE REMOVAL SHEET

ROADWAY RECONSTRUCTION, MAINTENANCE & CAMPGROUND ELECTRICAL FOR:

MAQUOKETA CAVES STATE PARK

JACKSON COUNTY, IOWA

DRAWN BY:	PROJECT NUMBER:
CHKD BY:	DATE:
	17-06-49-02
	October 2017

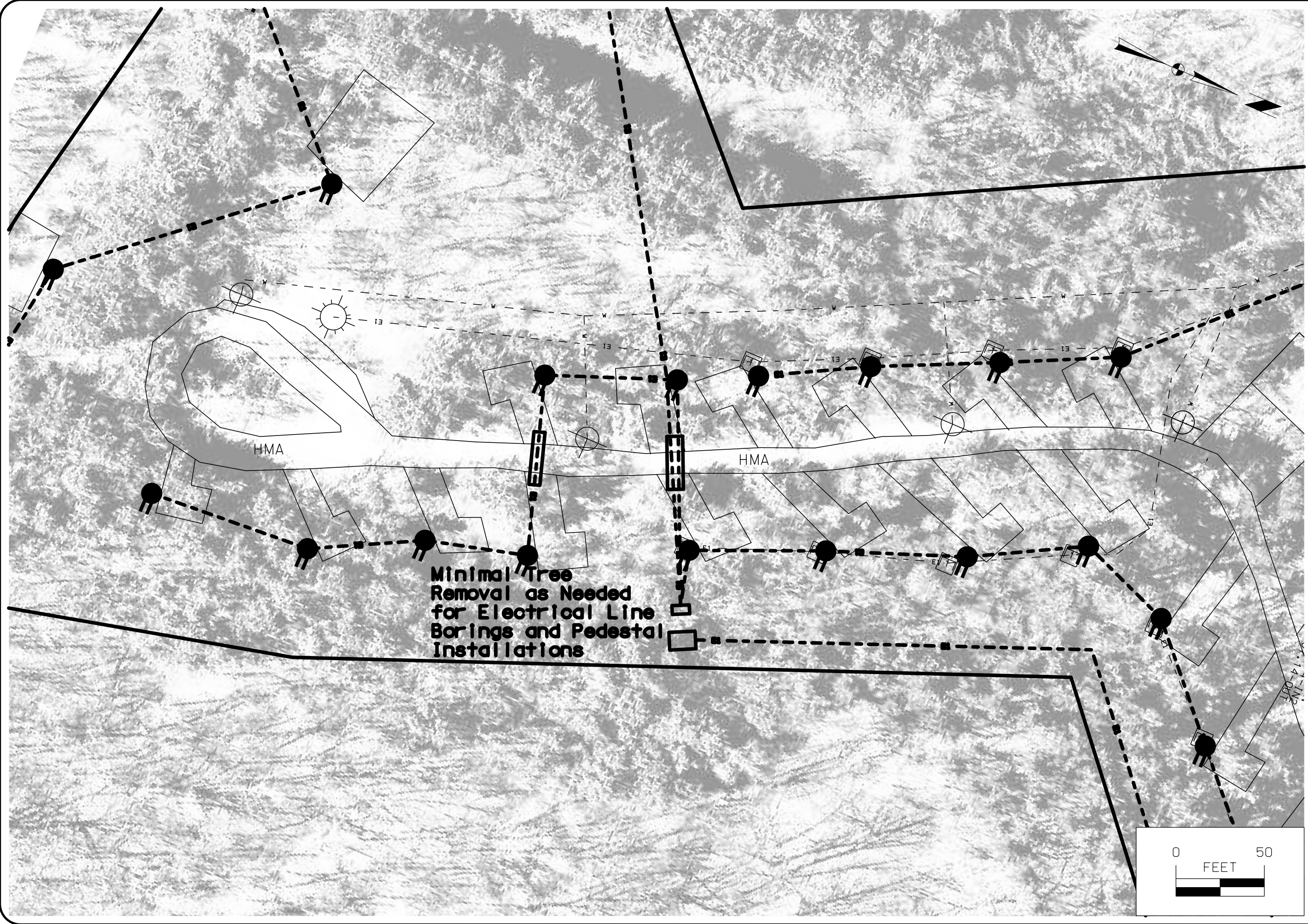

CONSULTANT:

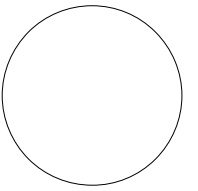

IOWA DEPARTMENT OF NATURAL RESOURCES

ENGINEERING SERVICES • WALLACE BUILDING
502 E. 9TH ST., DES MOINES, IA 50319-0034



TREE REMOVAL SHEET

ROADWAY RECONSTRUCTION, MAINTENANCE & CAMPGROUND ELECTRICAL FOR:

MAQUOKETA CAVES STATE PARK

JACKSON COUNTY, IOWA

NO.	BY	REVISION

DRAWN BY: PROJECT NUMBER:
17-06-49-02

CHKD BY: DATE:
October 2017

9:44:31 AM 10/27/2017 maldric

N:\Conservation Recreation\Land and Waters\Engineering\PROJECTS\ACTIVE\JACKSON\17-06-49-02 Maquoketa Caves Road Reconstr-02 Design\17-06-49-02 Maquoketa Caves Road Reconstr-02

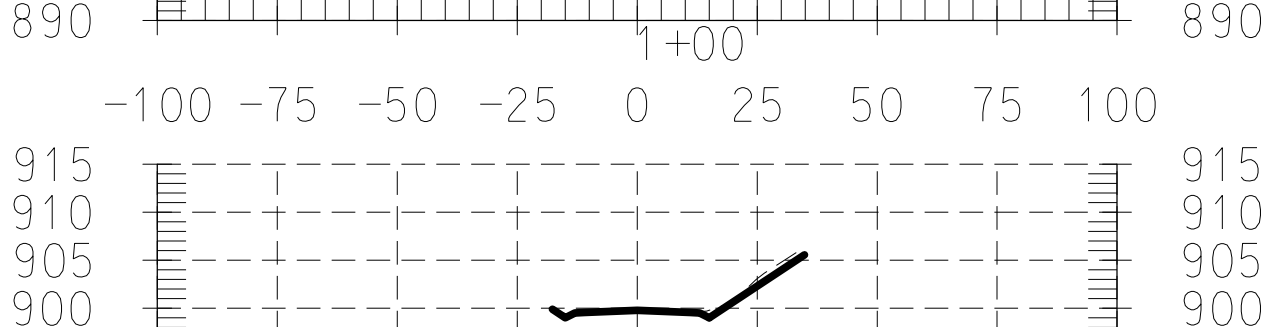
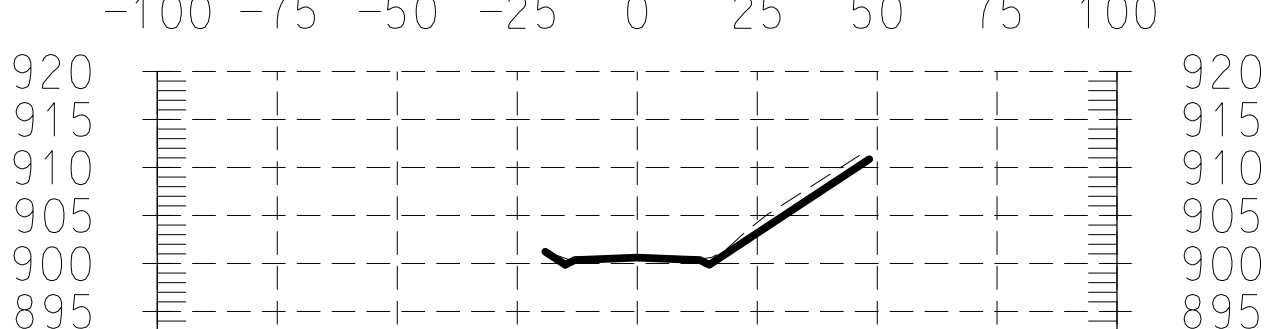
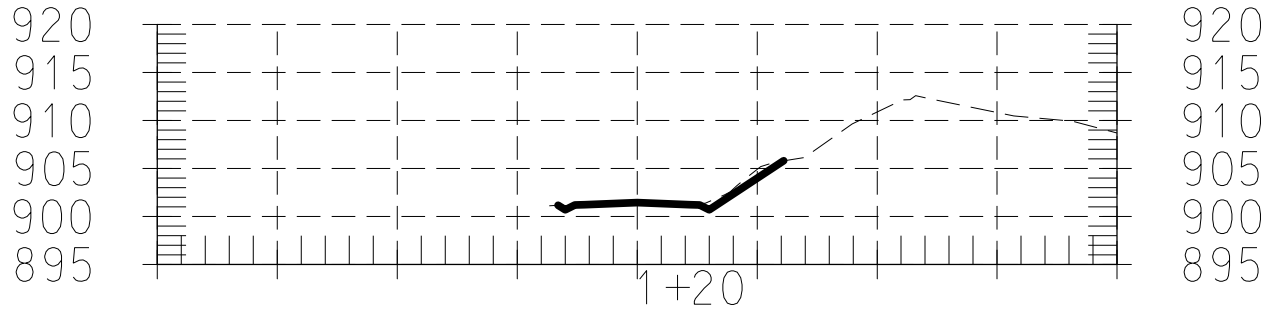
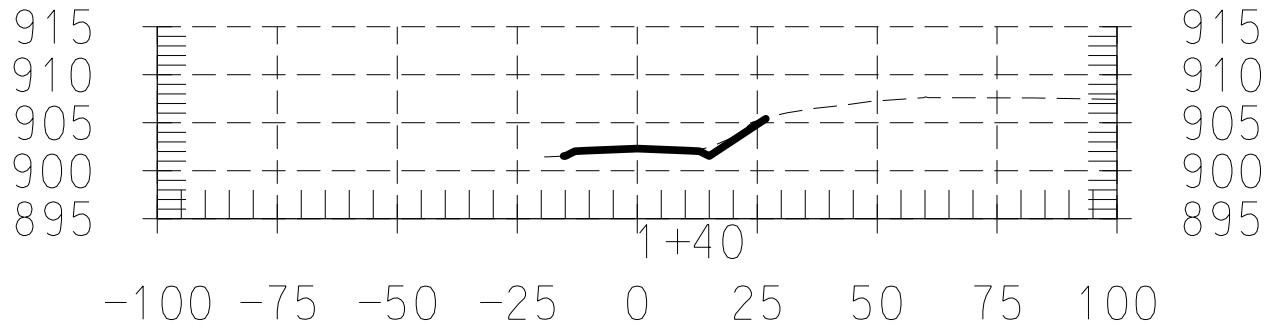
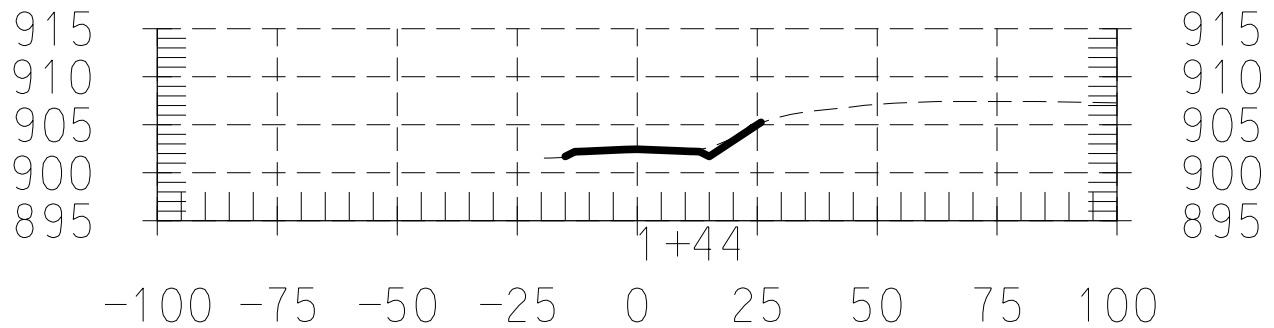
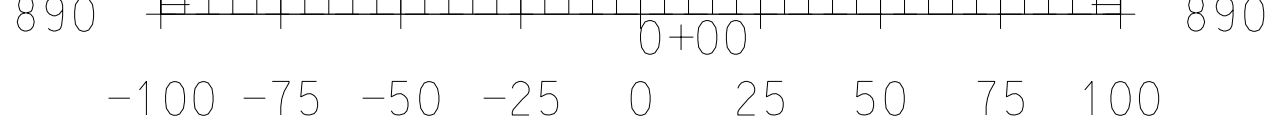
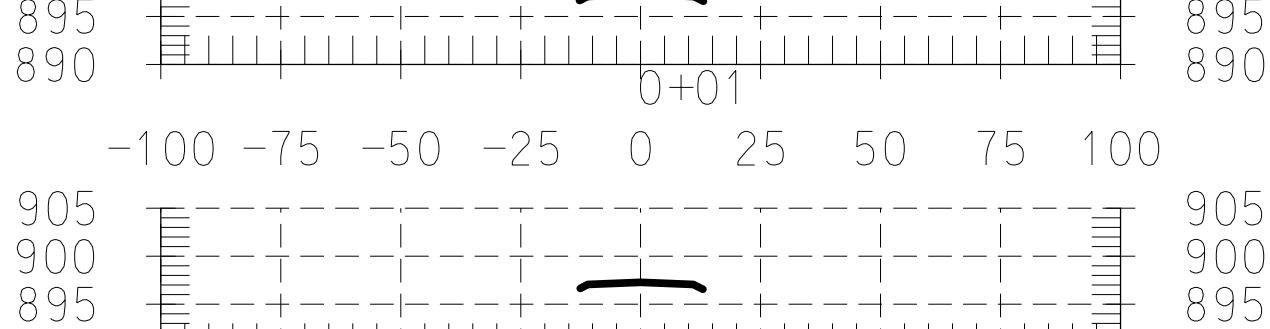
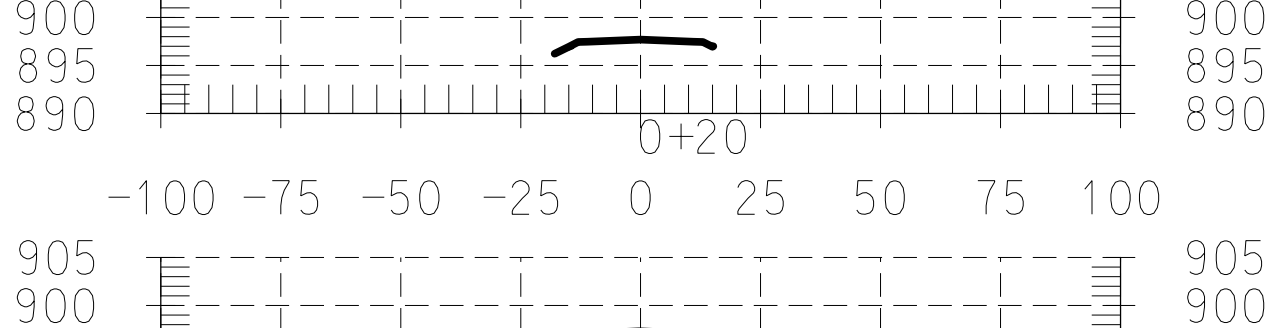
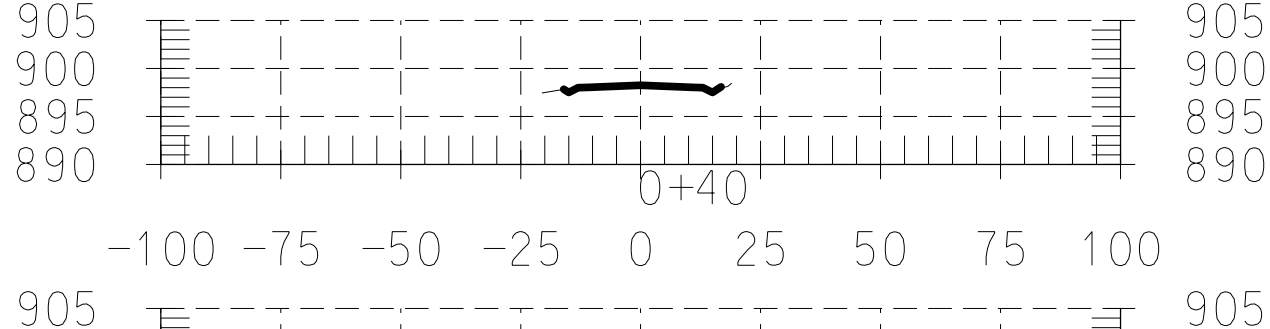
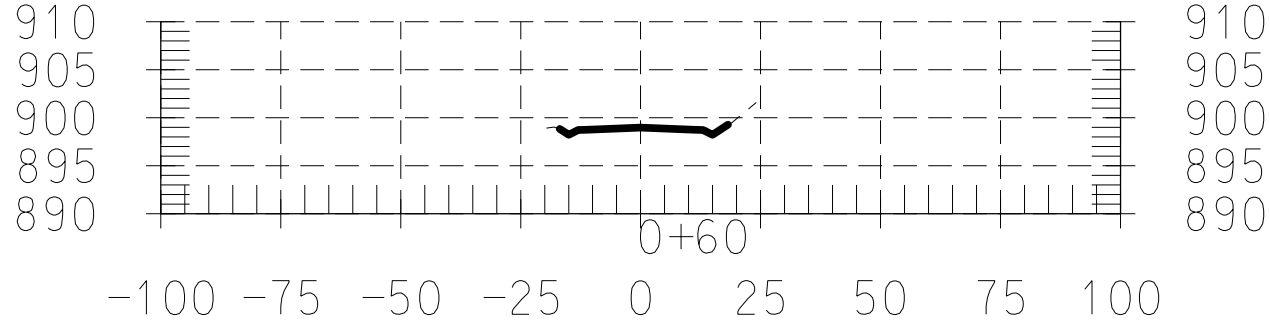
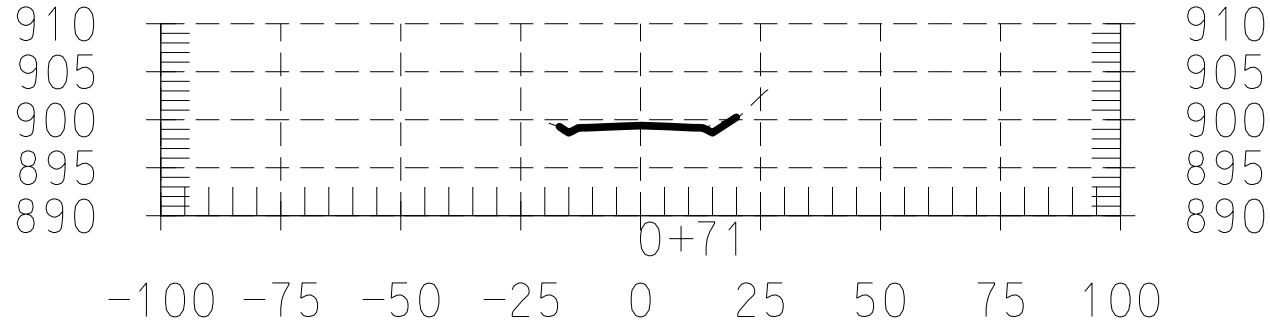

CONSULTANT:

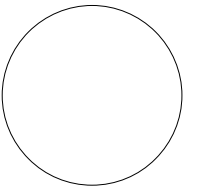

**IOWA DEPARTMENT OF
NATURAL RESOURCES**
ENGINEERING SERVICES - WALLACE BUILDING
502 E. 9TH ST., DES MOINES, IA 50319-0034



CROSS SECTION SHEET

ROADWAY RECONSTRUCTION, MAINTENANCE &
CAMPGROUND ELECTRICAL FOR:
MAQUOKETA CAVES STATE PARK
JACKSON COUNTY, IOWA

NO.	BY	REVISION

DRAWN BY: PROJECT NUMBER:
17-06-49-02

CHK'D BY: DATE:
October 2017

9:44:33 AM 10/27/2017 maldric N:\Conservation Recreation\Land and Waters\Engineering\PROJECTS\ACTIVE\JACKSON\17-06-49-02 Maquoketa Caves Road Reconstr. Repair\02 Design\17-06-49-02 Maquoketa Caves Road Reconstr.Repair\02

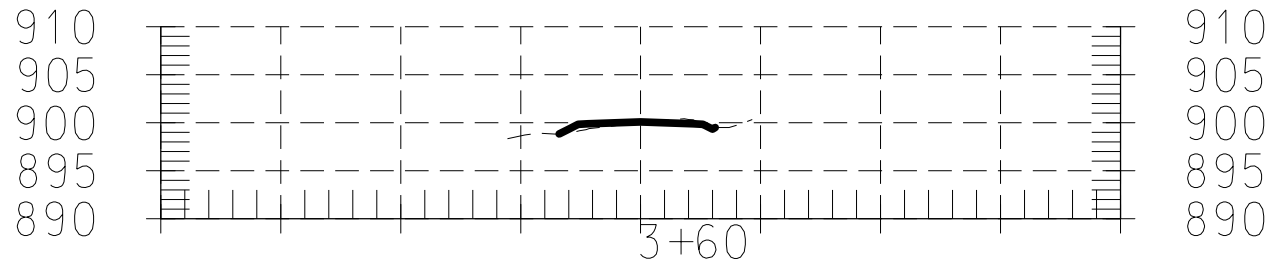

-100 -75 -50 -25 0 25 50 75 100

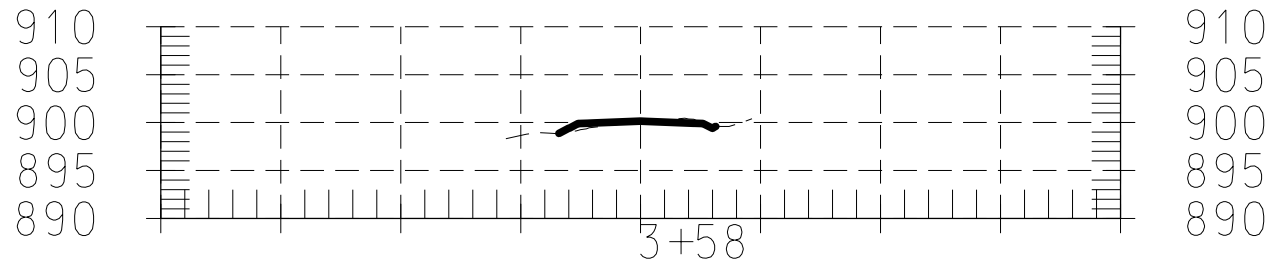

-100 -75 -50 -25 0 25 50 75 100

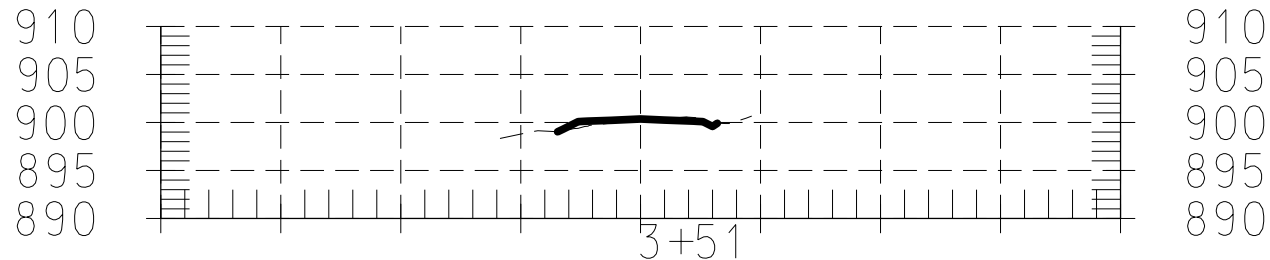

-100 -75 -50 -25 0 25 50 75 100

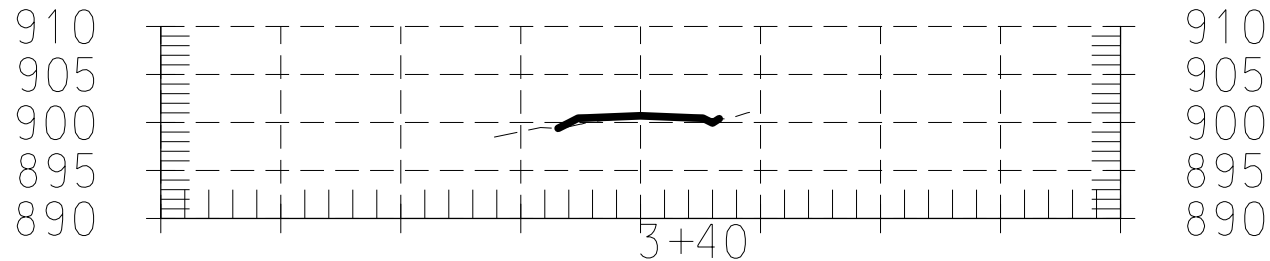

-100 -75 -50 -25 0 25 50 75 100

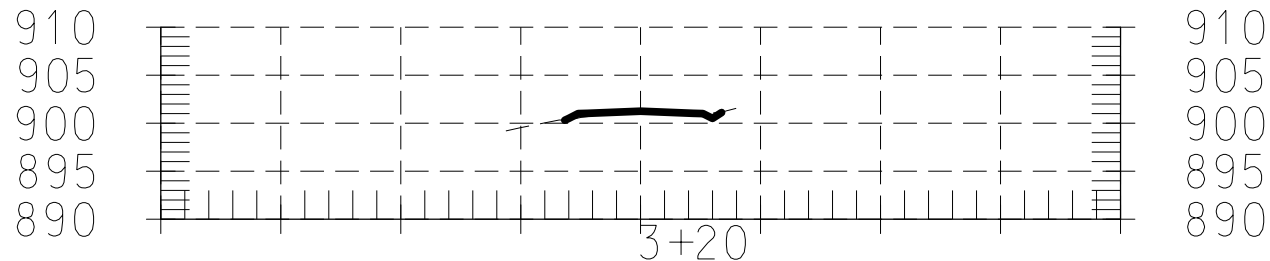

-100 -75 -50 -25 0 25 50 75 100

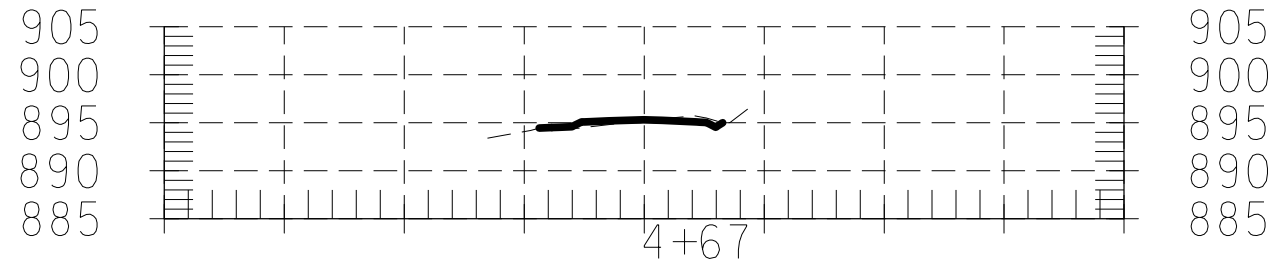

-100 -75 -50 -25 0 25 50 75 100

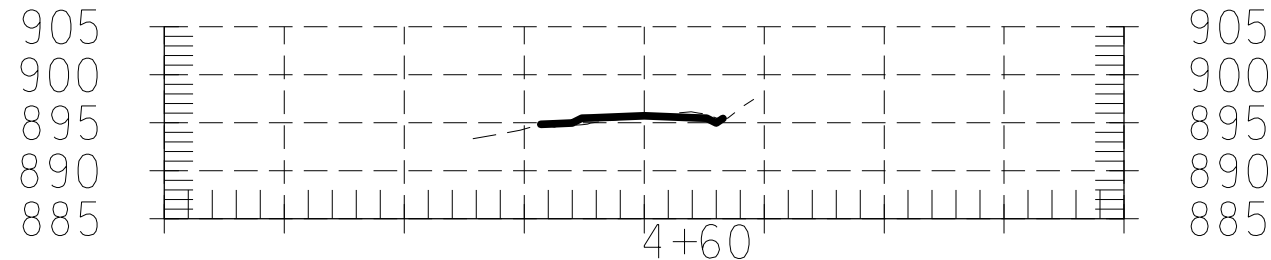

-100 -75 -50 -25 0 25 50 75 100

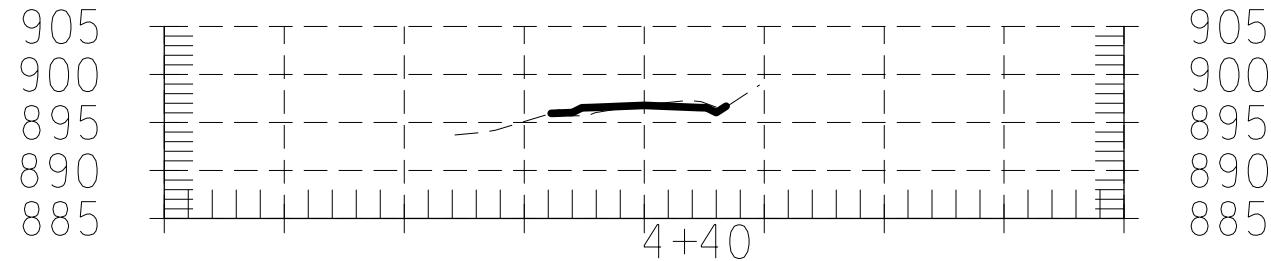

-100 -75 -50 -25 0 25 50 75 100

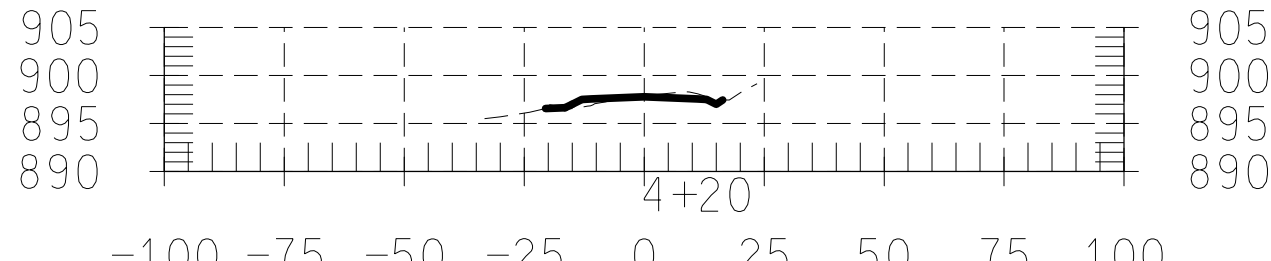

-100 -75 -50 -25 0 25 50 75 100

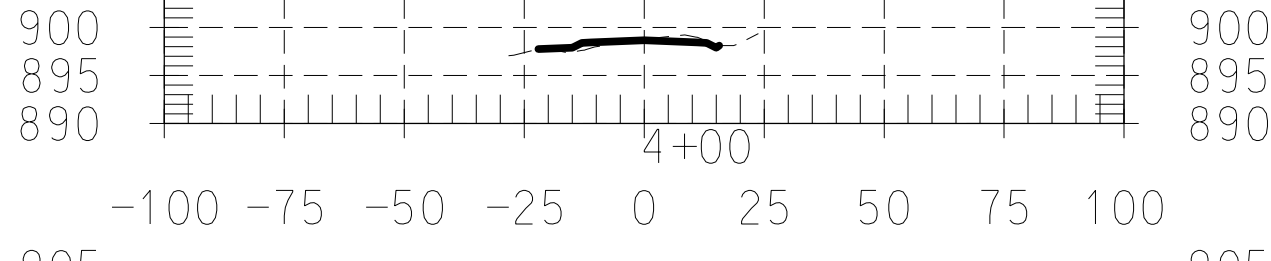

-100 -75 -50 -25 0 25 50 75 100

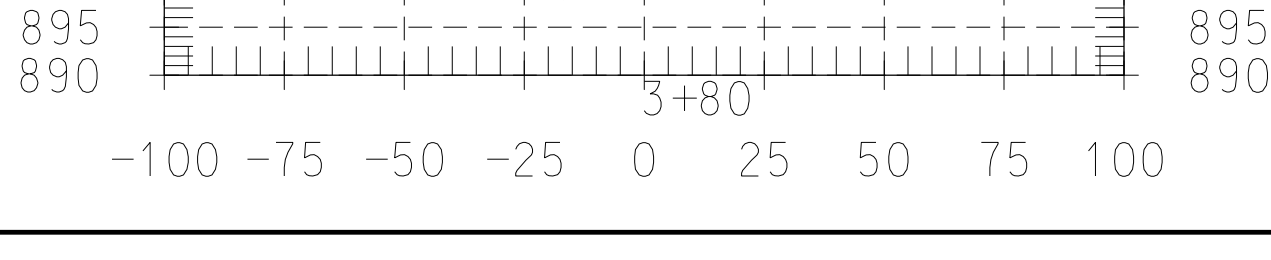

-100 -75 -50 -25 0 25 50 75 100

CONSULTANT:

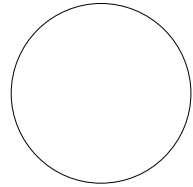

IOWA DEPARTMENT OF NATURAL RESOURCES

ENGINEERING SERVICES - WALLACE BUILDING
502 E. 9TH ST., DES MOINES, IA 50319-0034



CROSS SECTION SHEET

ROADWAY RECONSTRUCTION, MAINTENANCE & CAMPGROUND ELECTRICAL FOR:

MAQUOKETA CAVES STATE PARK

JACKSON COUNTY, IOWA

NO.	BY	REVISION

DRAWN BY: PROJECT NUMBER:
17-06-49-02

CHK'D BY: DATE:
October 2017

X.03

9:44:35 AM 10/27/2017 maldric

N:\Conservation Recreation\Land and Waters\Engineering\PROJECTS\ACTIVE\JACKSON\#17-06-49-02 Maquoketa Caves Road Reconstr-Repair\02 Design\17-06-49-02 Maquoketa Caves Road Reconstr-Repair\02

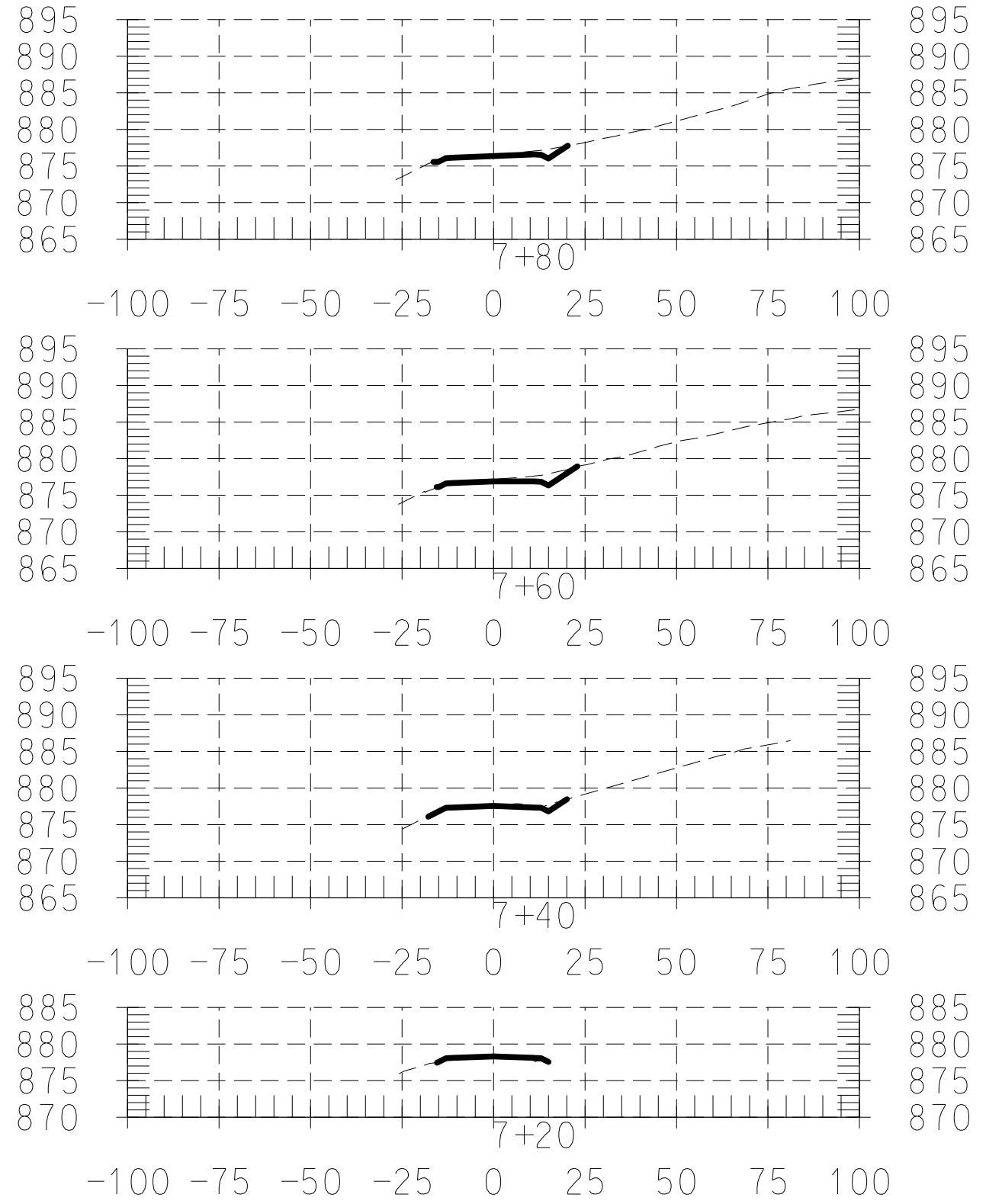
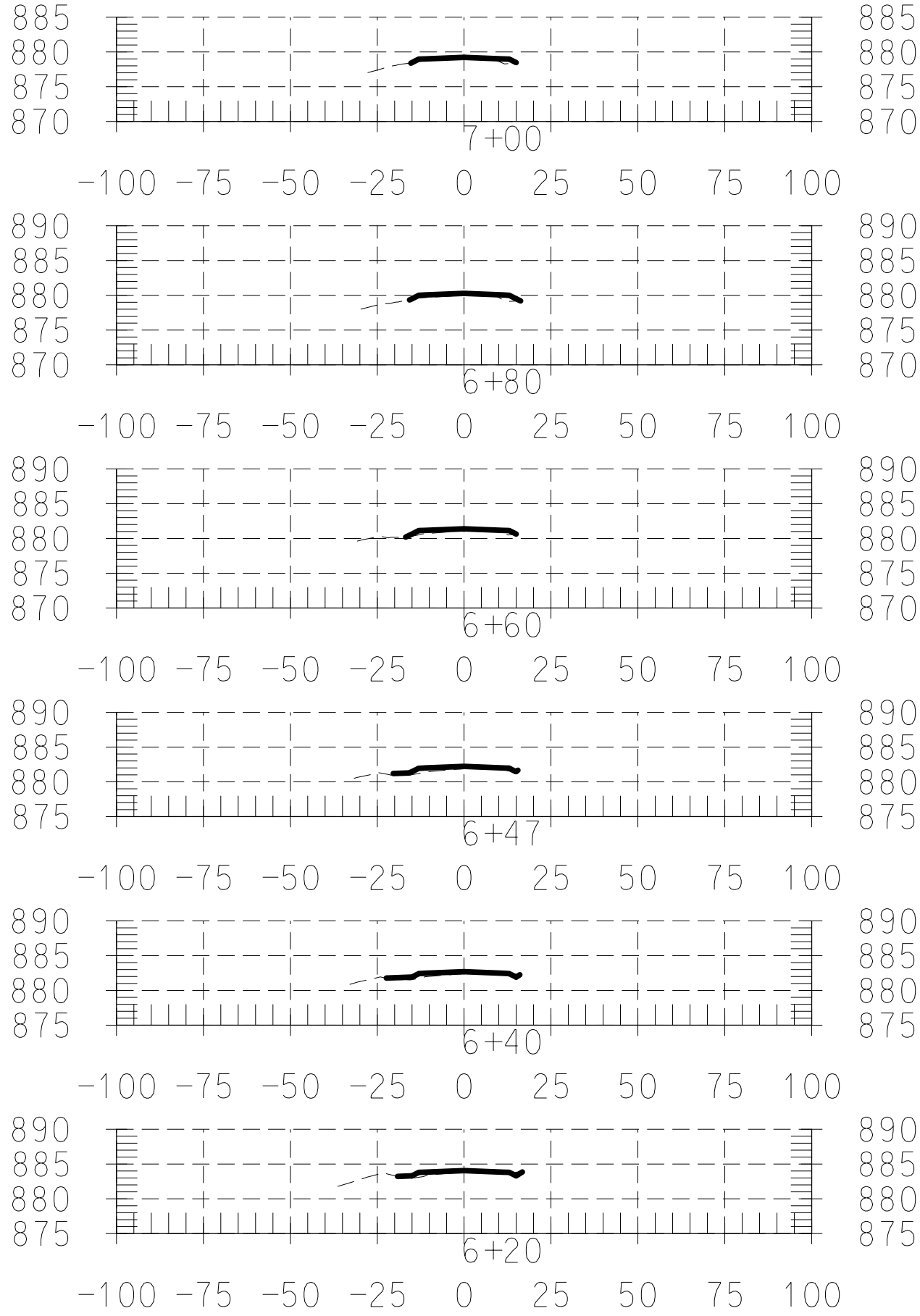

NO.	BY	REVISION

DRAWN BY: PROJECT NUMBER: 17-06-49-02

CHK'D BY: DATE: October 2017

CROSS SECTION SHEET
 ROADWAY RECONSTRUCTION, MAINTENANCE & CAMPGROUND ELECTRICAL FOR:
MAQUOKETA CAVES STATE PARK
 JACKSON COUNTY, IOWA



IOWA DEPARTMENT OF NATURAL RESOURCES
 ENGINEERING SERVICES - WALLACE BUILDING
 502 E. 9TH ST., DES MOINES, IA 50319-0034

CONSULTANT:

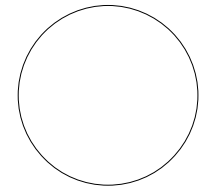

9:44:38 AM 10/27/2017 maldric N:\Conservation Recreation\Land and Waters\Engineering\PROJECTS\ACTIVE\JACKSON\17-06-49-02 Maquoketa Caves Road Reconstr. Repair\02 Design\17-06-49-02 Maquoketa Caves Road Reconstr. Repair\02

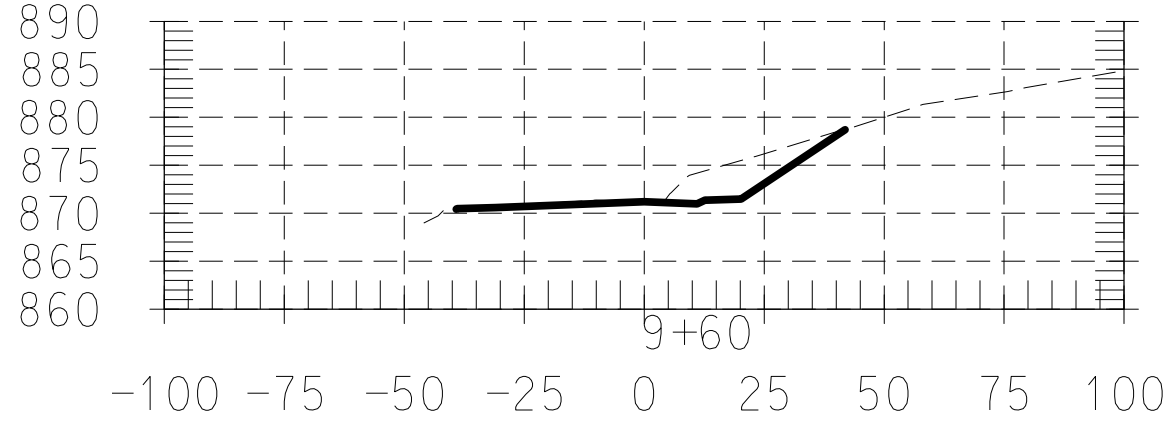
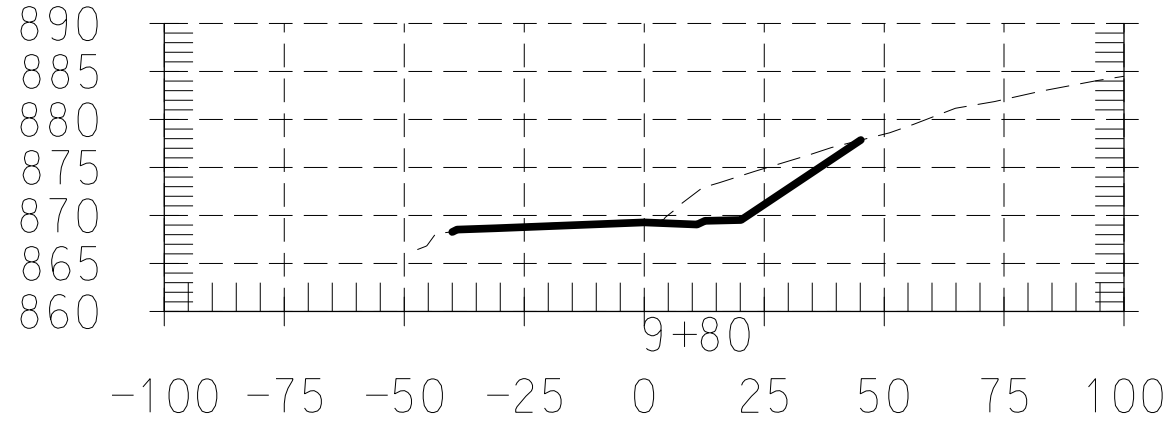
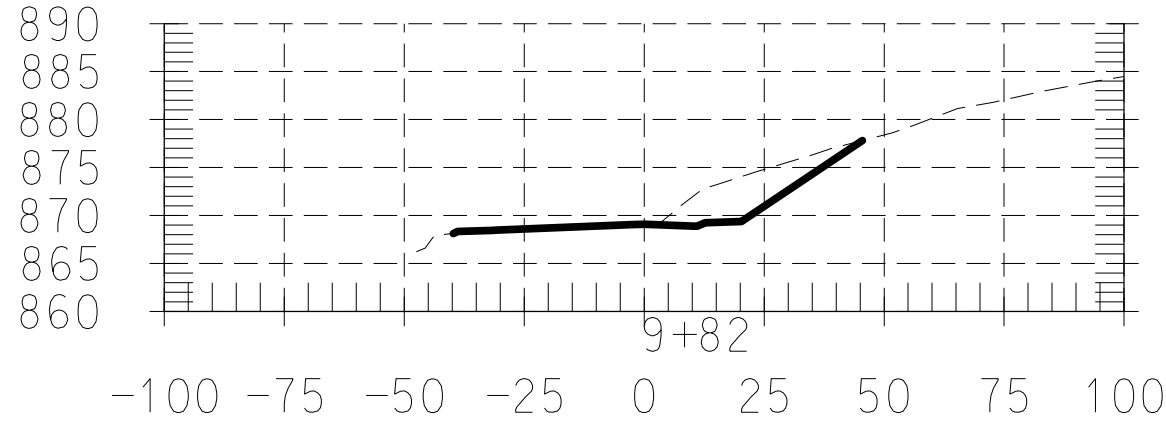
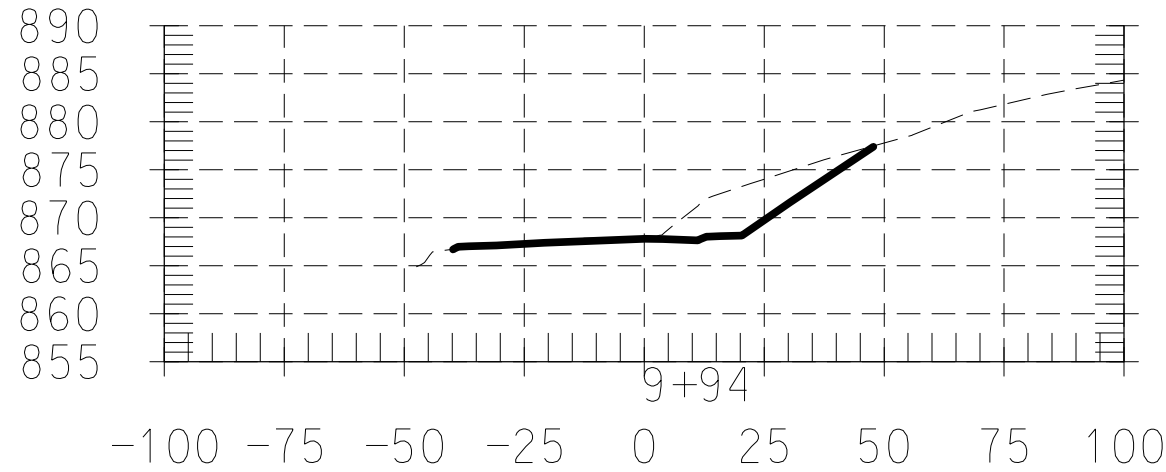
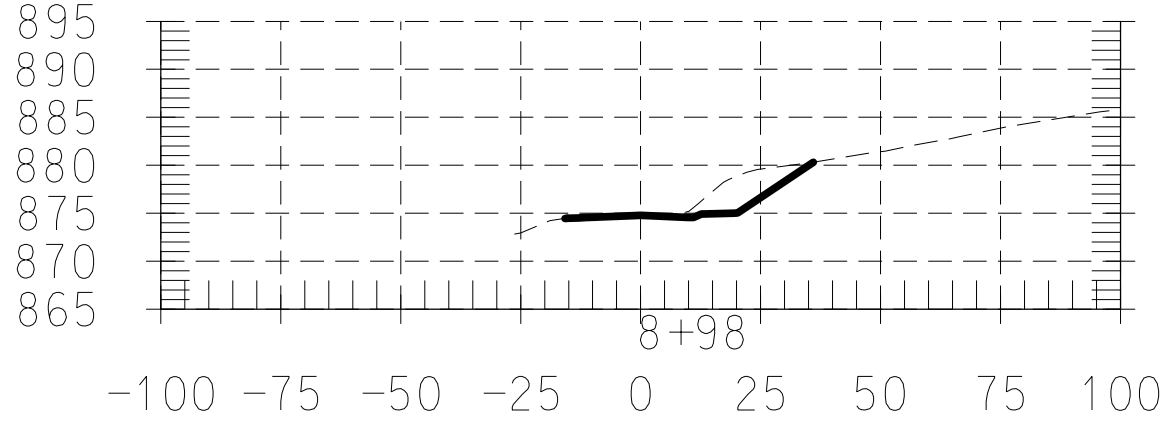
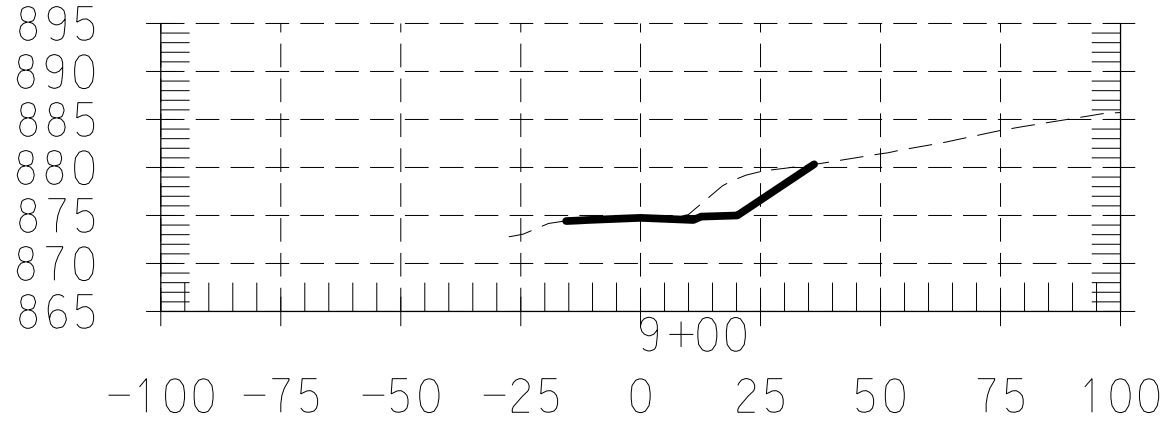
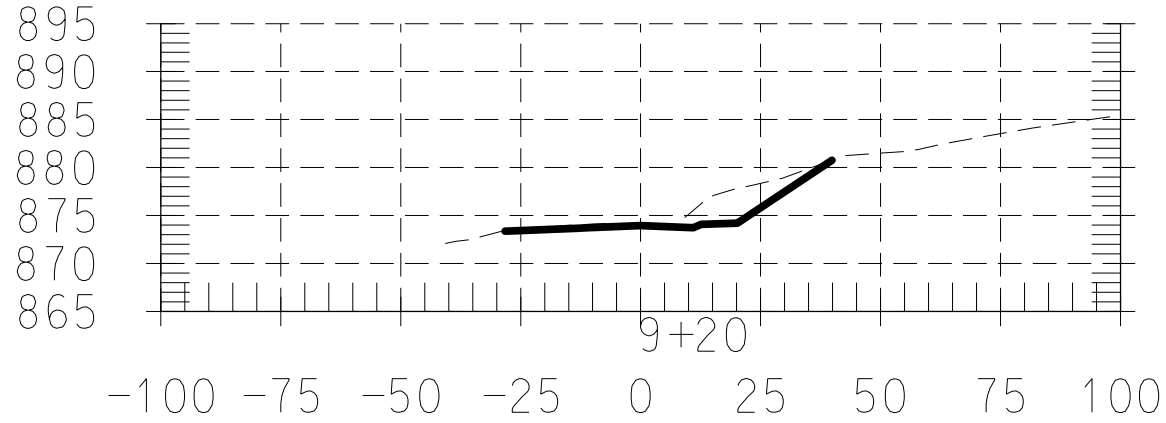
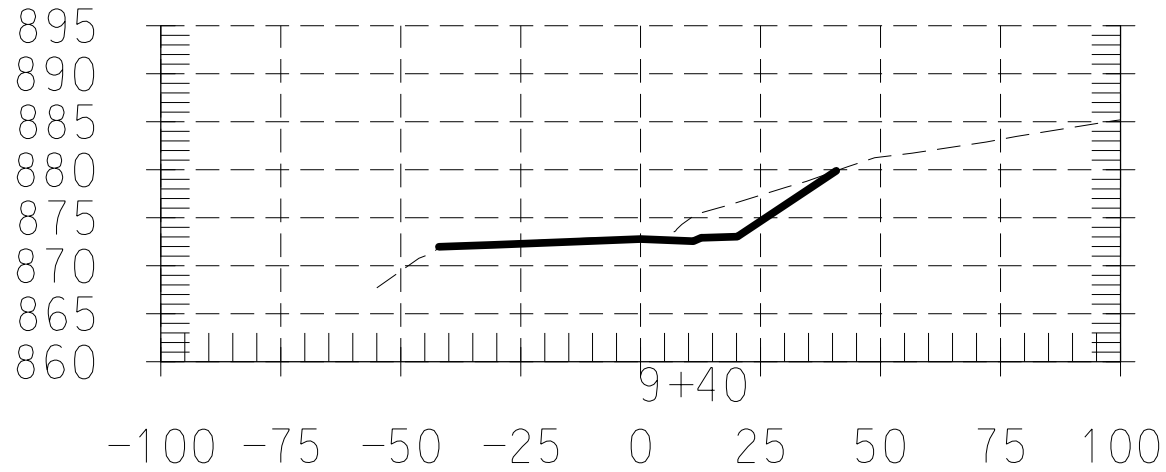

CONSULTANT:

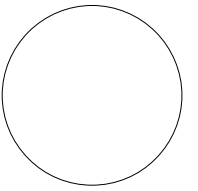

**IOWA DEPARTMENT OF
NATURAL RESOURCES**
ENGINEERING SERVICES - WALLACE BUILDING
502 E. 9TH ST., DES MOINES, IA 50319-0034



CROSS SECTION SHEET

ROADWAY RECONSTRUCTION, MAINTENANCE &
CAMPGROUND ELECTRICAL FOR:

MAQUOKETA CAVES STATE PARK

JACKSON COUNTY, IOWA

NO.	BY	REVISION

DRAWN BY: PROJECT NUMBER:
17-06-49-02
CHK'D BY: DATE:
October 2017

9:44:40 AM 10/27/2017 maldric N:\Conservation Recreation\Land and Waters\Engineering\PROJECTS\ACTIVE\JACKSON\17-06-49-02 Maquoketa Caves Road Reconstr-Repair\02 Design\17-06-49-02 Maquoketa Caves Road Reconstr-Repair\02

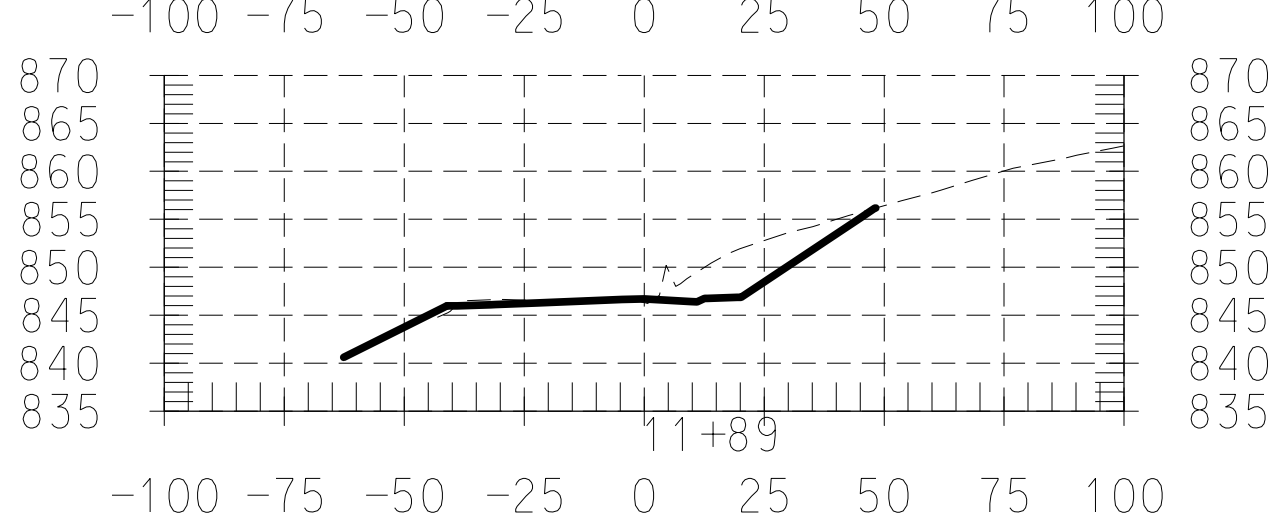
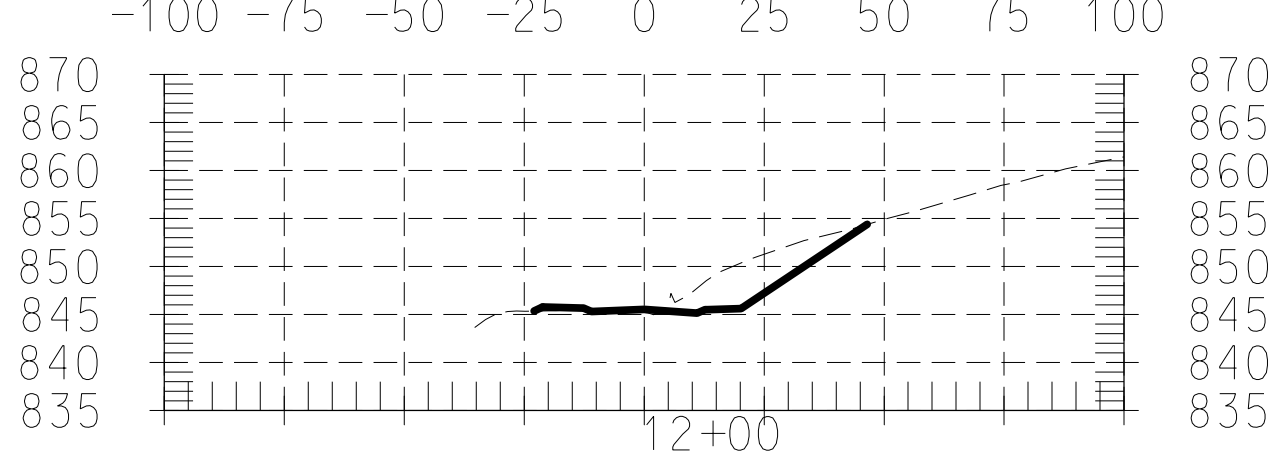
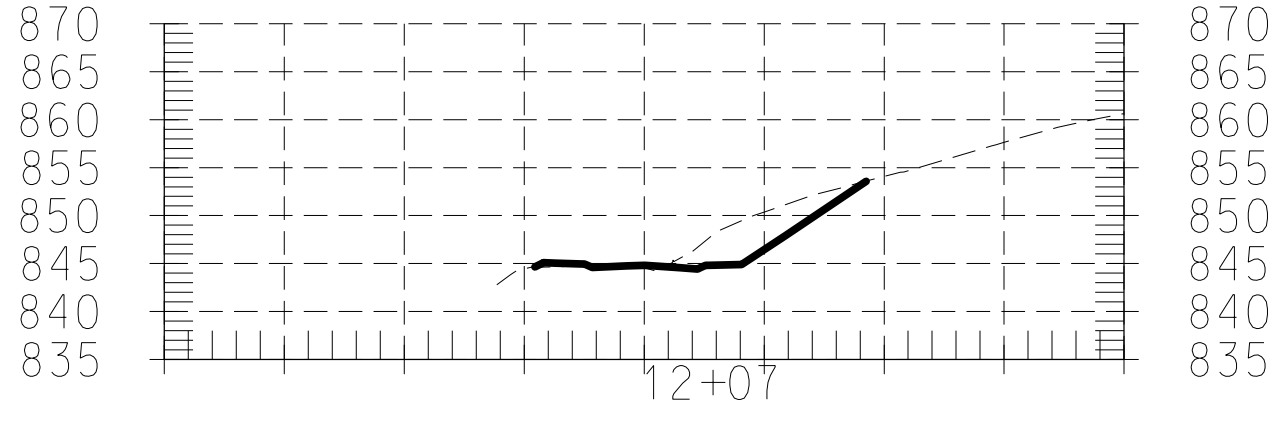
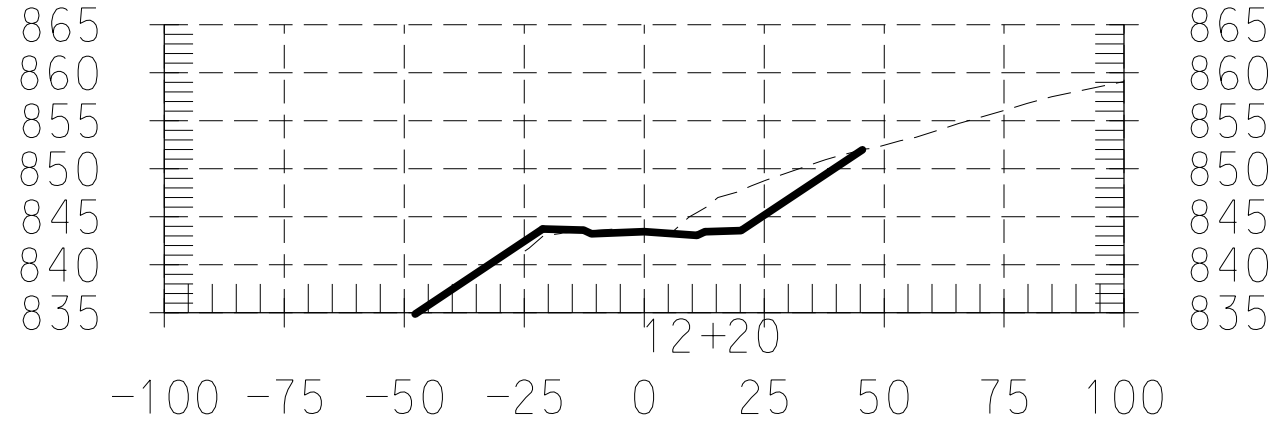
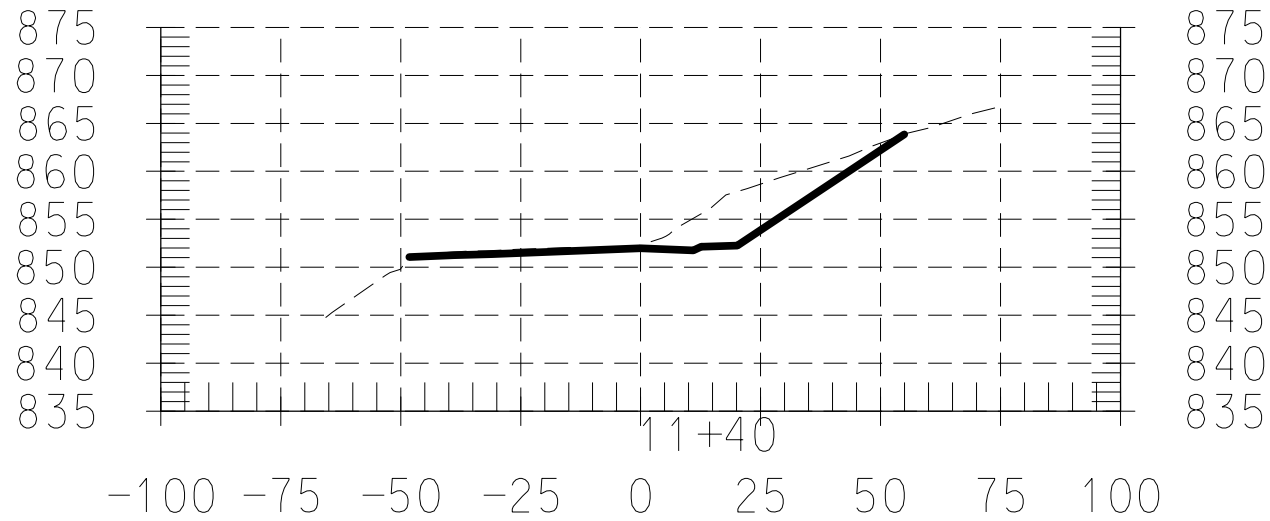
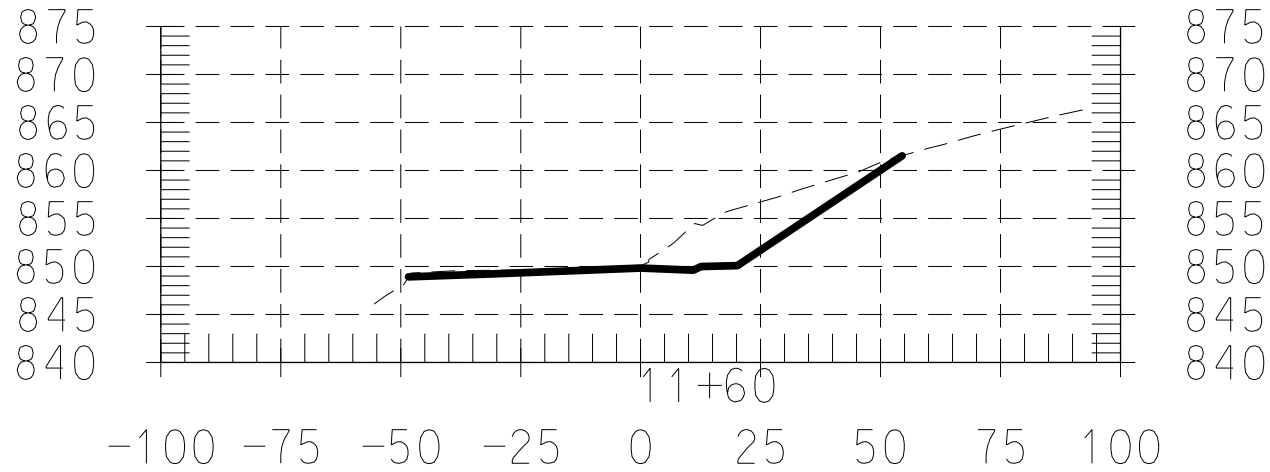
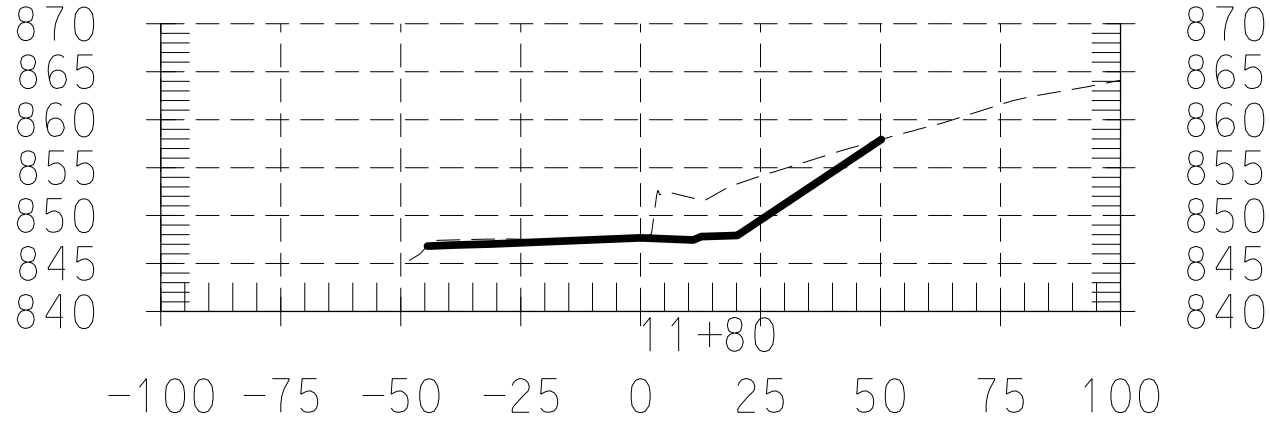

CONSULTANT:

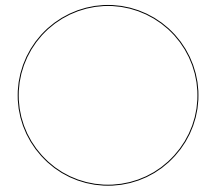

IOWA DEPARTMENT OF NATURAL RESOURCES
ENGINEERING SERVICES • WALLACE BUILDING
502 E. 9TH ST., DES MOINES, IA 50319-0034



CROSS SECTION SHEET

ROADWAY RECONSTRUCTION, MAINTENANCE & CAMPGROUND ELECTRICAL FOR:
MAQUOKETA CAVES STATE PARK

JACKSON COUNTY, IOWA

NO.	BY DATE	REVISION

DRAWN BY: PROJECT NUMBER:
17-06-49-02
CHK'D BY: DATE:
October 2017

9:44:43 AM 10/27/2017 maldric

N:\Conservation Recreation\Land and Waters\Engineering\PROJECTS\ACTIVE\JACKSON\#17-06-49-02 Maquoketa Caves Road Reconstr-02 Design\17-06-49-02 Maquoketa Caves Road Reconstr-02

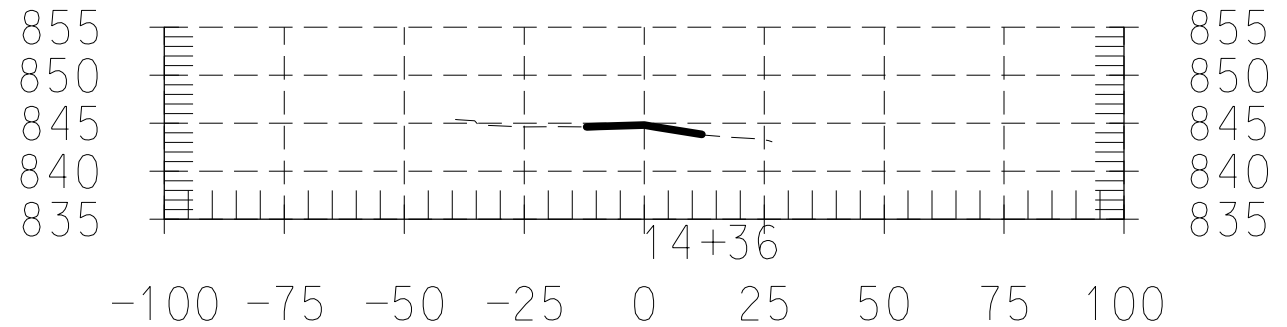
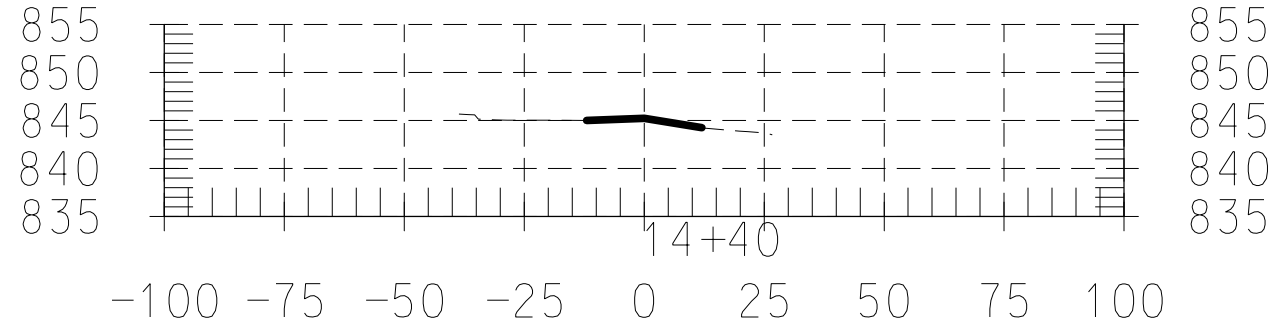
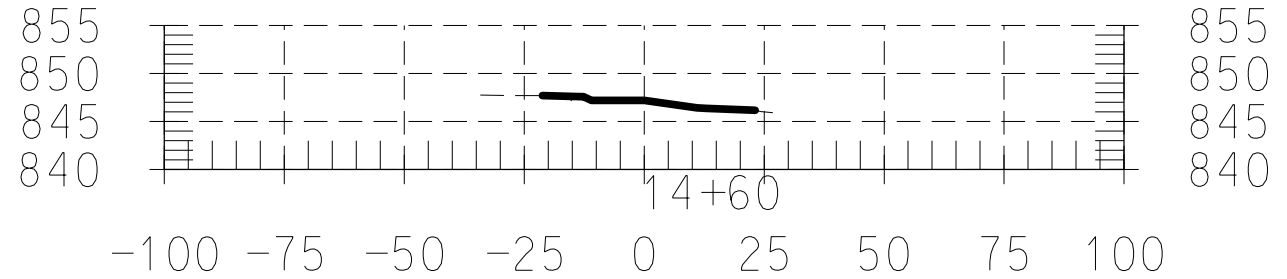
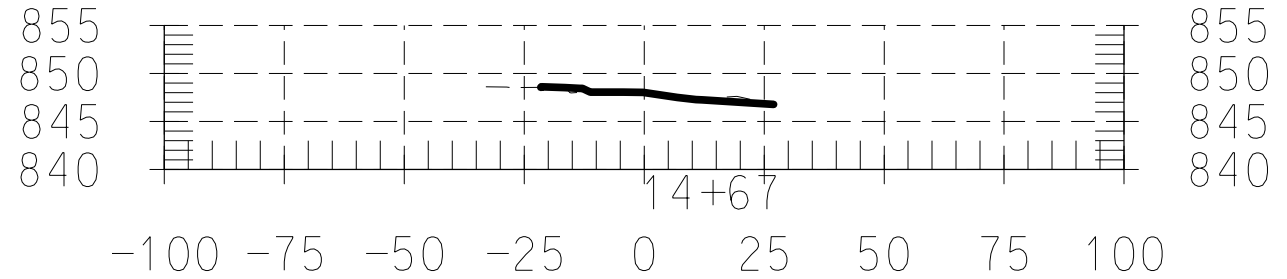
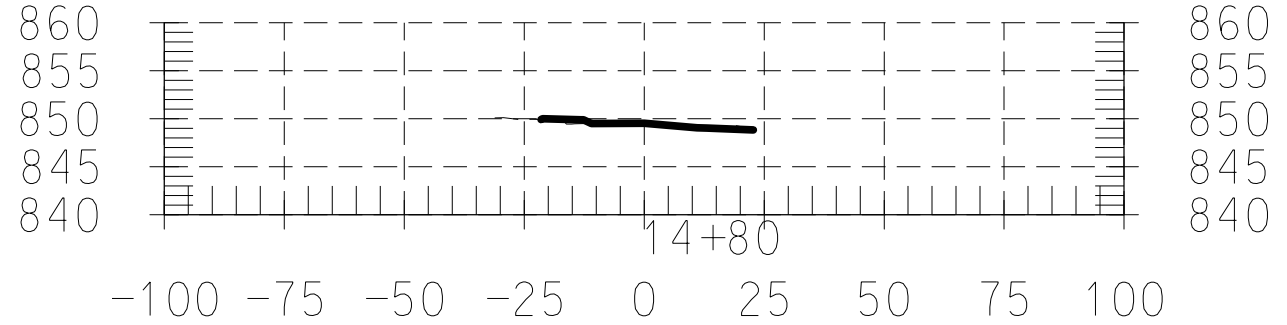
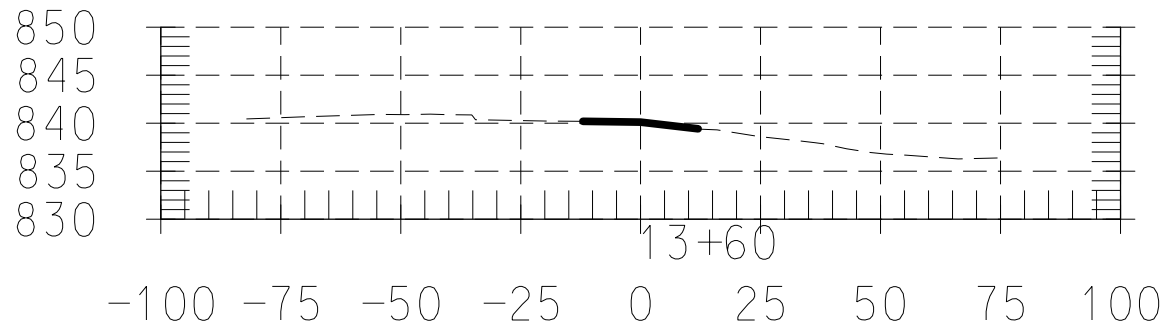
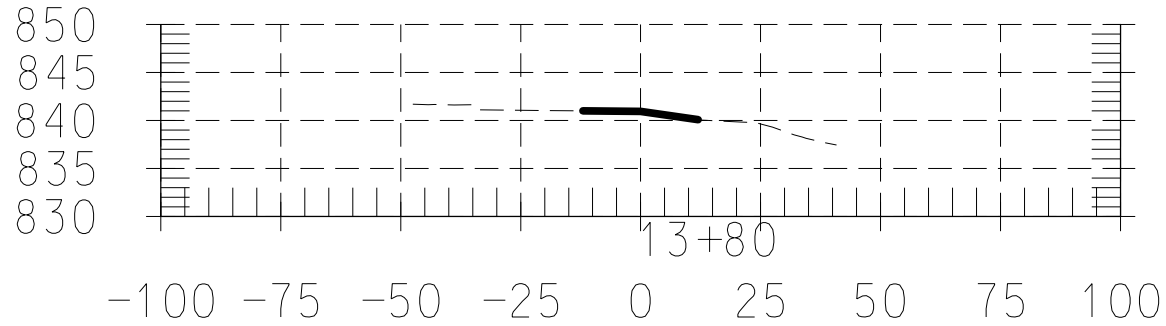
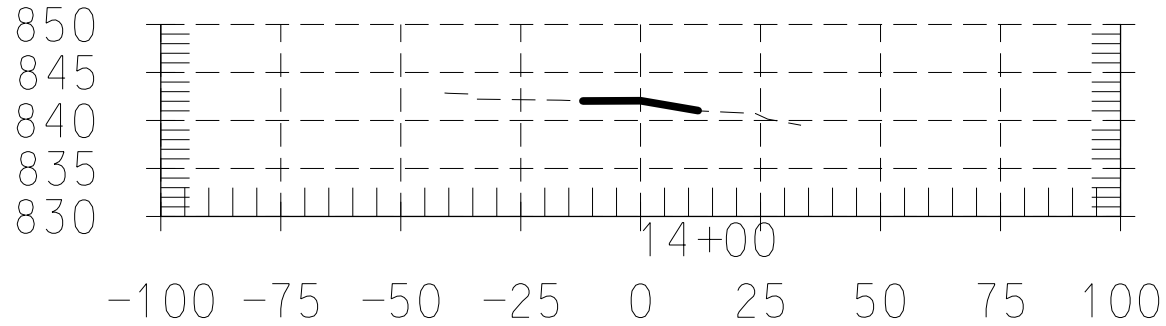
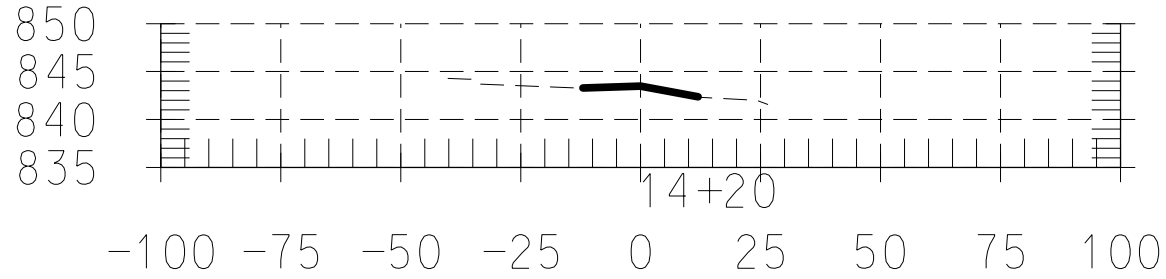
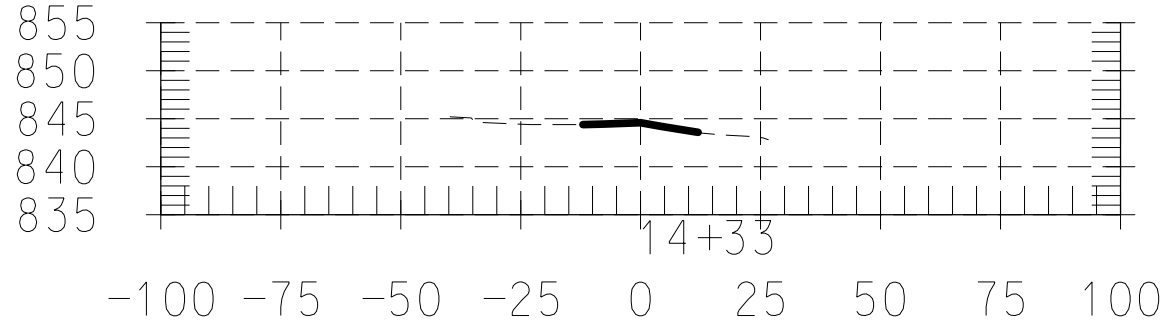

CONSULTANT:

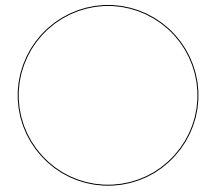

**IOWA DEPARTMENT OF
NATURAL RESOURCES**
ENGINEERING SERVICES - WALLACE BUILDING
502 E. 9TH ST., DES MOINES, IA 50319-0034



CROSS SECTION SHEET

ROADWAY RECONSTRUCTION, MAINTENANCE & CAMPGROUND ELECTRICAL FOR:

MAQUOKETA CAVES STATE PARK

JACKSON COUNTY, IOWA

NO.	BY	REVISION

DRAWN BY: PROJECT NUMBER:
17-06-49-02
CHK'D BY: DATE:
October 2017

9:44:44 AM 10/27/2017 maldric

N:\Conservation Recreation\Land and Waters\Engineering\PROJECTS\ACTIVE\JACKSON\17-06-49-02 Maquoketa Caves Road Reconstr. Repair\02 Design\17-06-49-02 Maquoketa Caves Road Reconstr. Repair\02

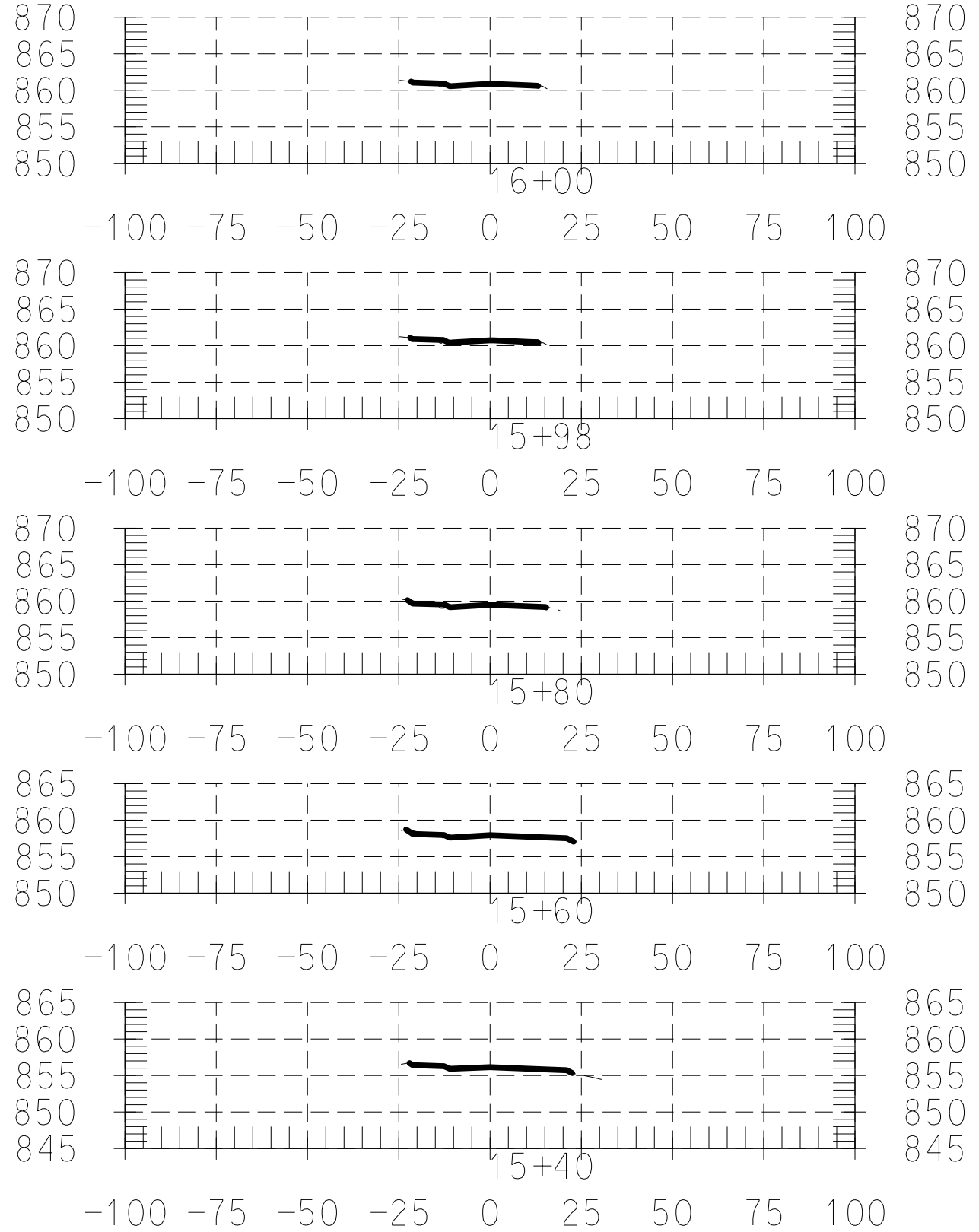
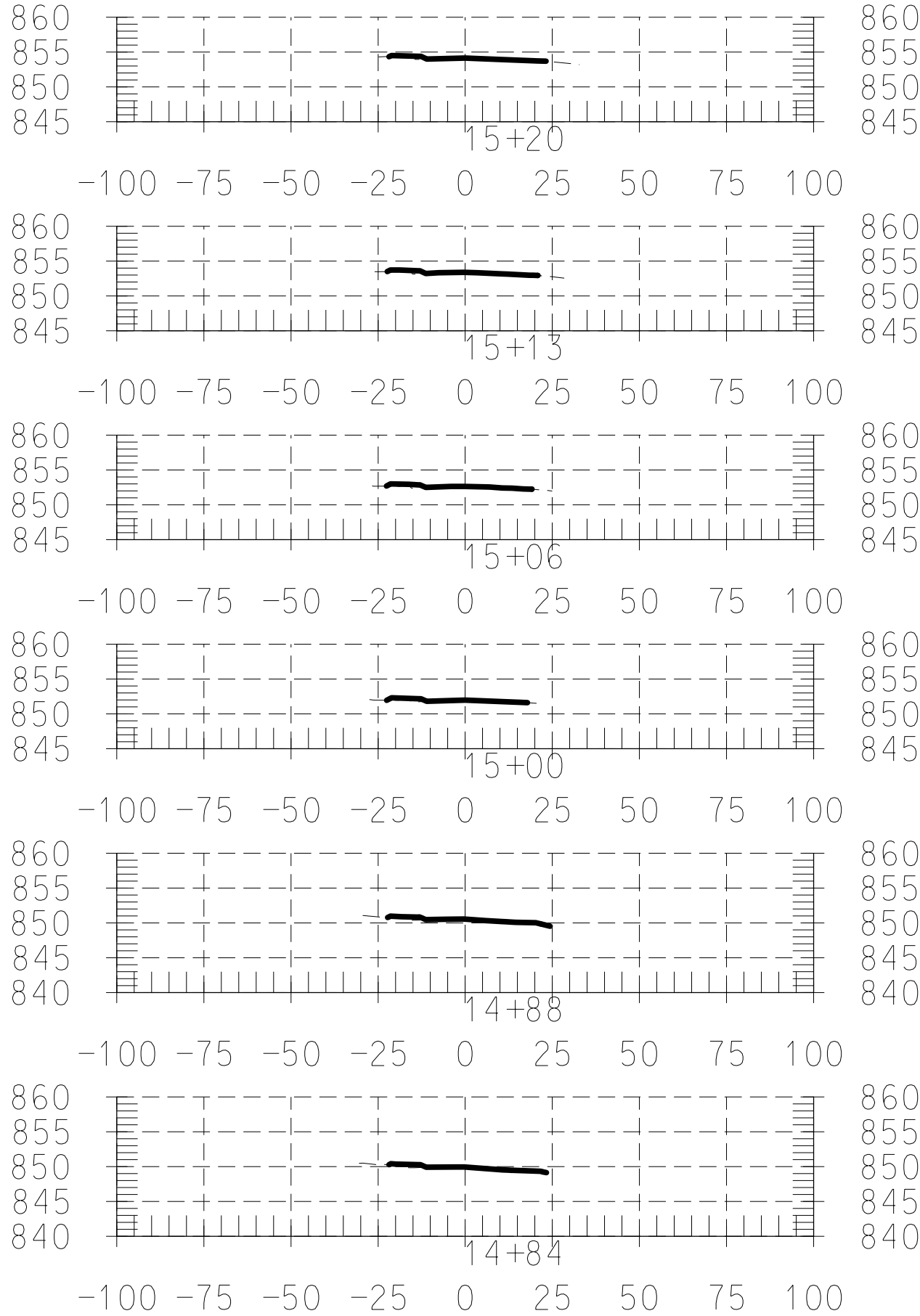

CONSULTANT:

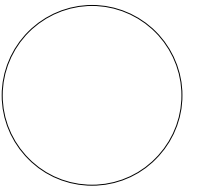

IOWA DEPARTMENT OF NATURAL RESOURCES
ENGINEERING SERVICES - WALLACE BUILDING
502 E. 9TH ST., DES MOINES, IA 50319-0034



CROSS SECTION SHEET

ROADWAY RECONSTRUCTION, MAINTENANCE & CAMPGROUND ELECTRICAL FOR:
MAQUOKETA CAVES STATE PARK

JACKSON COUNTY, IOWA

NO.	BY	REVISION

DRAWN BY: PROJECT NUMBER:
17-06-49-02
CHK'D BY: DATE:
October 2017

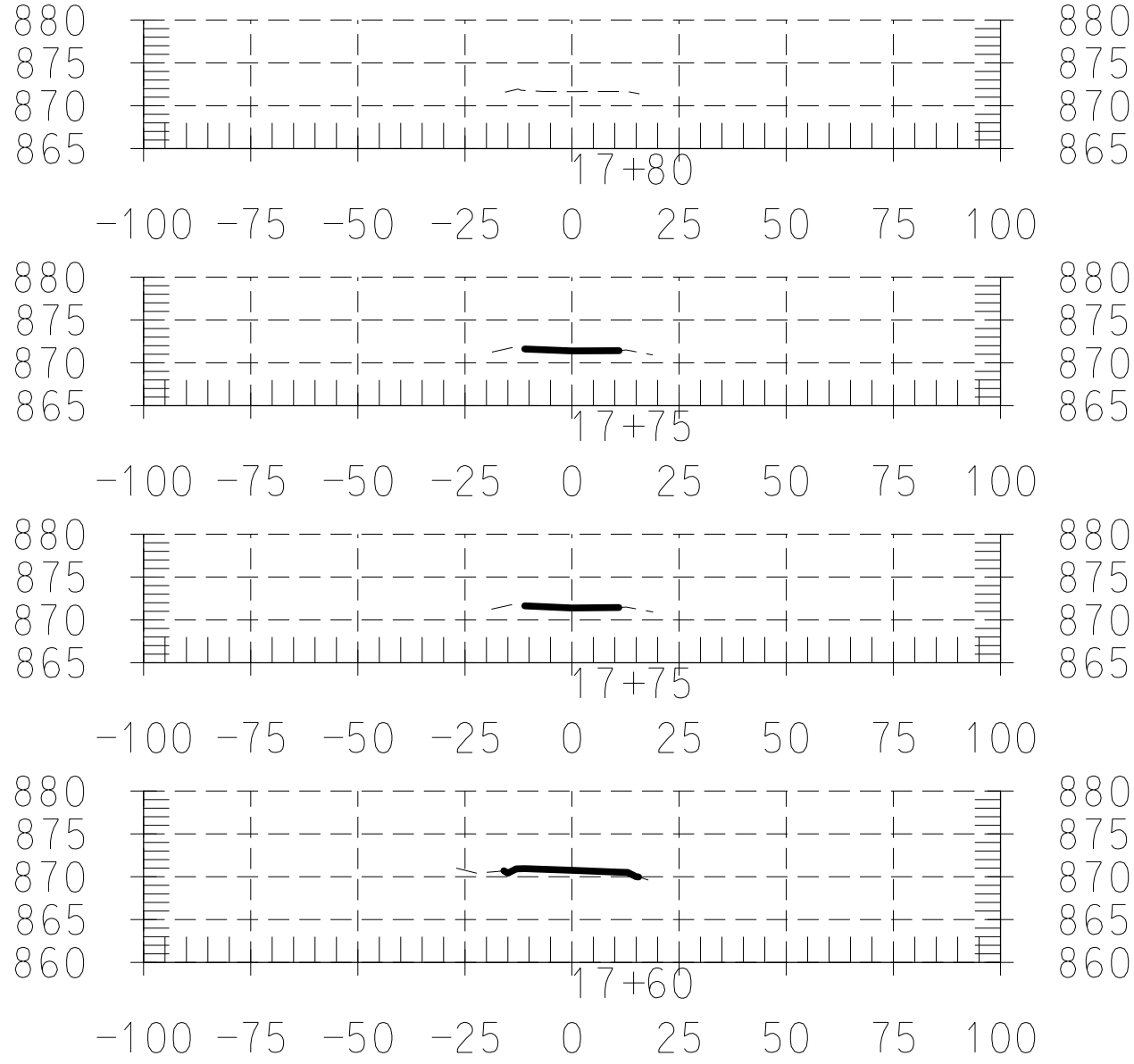

CONSULTANT:

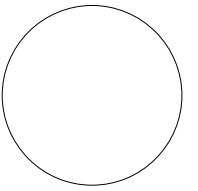

IOWA DEPARTMENT OF NATURAL RESOURCES
ENGINEERING SERVICES - WALLACE BUILDING
502 E. 9TH ST., DES MOINES, IA 50319-0034



CROSS SECTION SHEET

ROADWAY RECONSTRUCTION, MAINTENANCE & CAMPGROUND ELECTRICAL FOR:
MAQUOKETA CAVES STATE PARK
JACKSON COUNTY, IOWA

NO.	BY DATE	REVISION

DRAWN BY:	PROJECT NUMBER:
CHK'D BY:	DATE:
	17-06-49-02
	October 2017